

GENERAL PURPOSE ENGINE

GXV160UH2

PARTS CATALOGUE

1

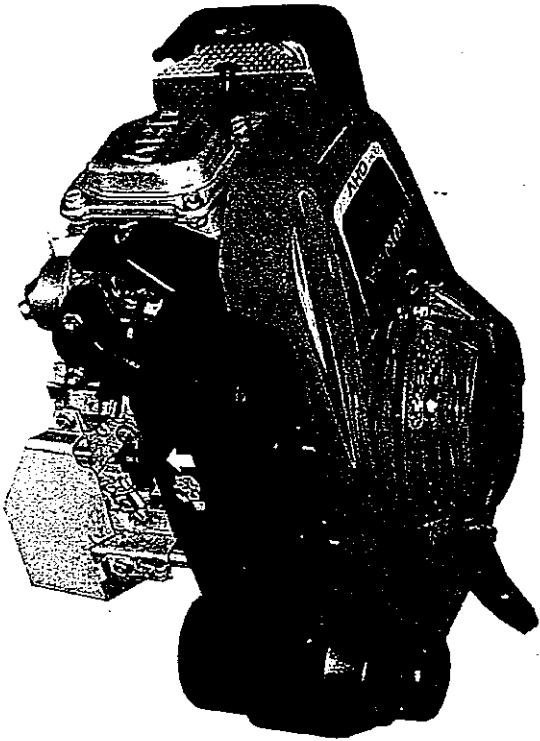

GXV160UH2

FOREWORD INDEX

1

ENGINE GROUP

2

PART NUMBER INDEX

3

PART NAME INDEX

4

Instruction for use of parts catalogue

- This parts catalogue was prepared based on the latest information available as of July 20, 2005.
- See the parts catalogue news for any revision that is made after July 20, 2005.
- **Always specify the part number when ordering a part.**
- Check the model, type, serial numbers, color, maker, and the size as needed before ordering a part.
- Note that the illustrations (part drawings) can differ from the actual parts in shape. They are given just to help you to refer to the parts.
- **When modifications or additions to this parts catalogue are made, a revised edition will be issued at an appropriate time, with successively progressing revision numbers on the cover. We recommend obtaining such revisions in order to keep your parts catalogue up-to-date at all times. To check whether a parts catalogue revision has been issued, please contact your Honda distributor.**

Initial version issue date

July 20, 2005
Honda Motor Co., Ltd.

B 1

CONTENTS

	Page	Address
	No.	
● Instruction for use of parts catalogue	1	B 1 1
● How to refer to the part information	2	B 2
● Part catalogue structure	3	B 3
● When the parts were revised	4	B 4
● Abbreviations used in the parts catalogue	4	B 4
● How to check the part block and serial numbers	5	B 5
● Models, parts catalogue codes and applicable serial numbers	6	B 6
● Features of each type	7	B 7
● Fuel hose, general purpose hoses and vinyl hose	8	B 8
● FLAT RATE SERVICE TIME	9	B 9
● Illustrated index	14	B14
● ENGINE GROUP	16	C 1 2
● PART NO. INDEX	39	E 1 3
● PART NAME INDEX	41	F 1 4

How to refer to the part information

Reference with "Illustrated index"

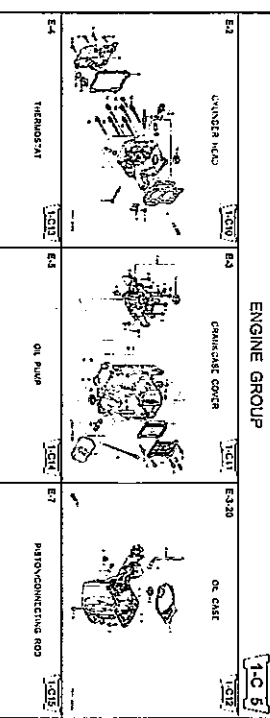

Reference with "Part number index"

Part Number	Address	Page	Ref.	Part Number	Address	Page
06000				13212-2W-000	1-C14	36
06316-4W-000	1-69	88	1	13220-2W-000	1-E8	35
				13332-2W-000	1-E11	55
11000				15400-PF8-000	1-C14	56
				15422-2W-000	1-C14	27
11320-2W-405	1-C11	27	1	15472-8E1-000	1-C14	30
11320-2W-405	1-C11	27	2	15611-2W-000	1-C10	22
11340-2W-000	1-C11	27	3	15655-2W-000	1-C11	22
11340-2W-000	1-C12	28	1			
11381-2W-003	1-E11	38	1			
12000				16000		
12000-2W-40974	1-C11	27	4	16010-2W-005	1-B4	36
12000-2W-409	1-C10	26	1	16011-2W-005	1-B4	36
12000-2W-409	1-C10	26	2	16012-2W-005	1-B4	36
12000-2W-409	1-C16	32	1	16013-2W-005	1-B4	36
12000-2W-409	1-C10	26	2	16023-2W-005	1-B4	36
12000-2W-409	1-E8	38	1	16024-2W-005	1-B4	36
12000-2W-409	1-E11	38	1	16028-2W-005	1-B4	36

Reference with "Part name index"

Part Name	Address	Page	Ref.
ABSORBER, FUEL	1-E15	43	5
ABRAUPTURE COMP.	1-B17	42	7
ARM COMP., LINK JOINT	1-G5	85	18
ARM COMP., SHIFT LINK	1-G5	85	18
ARM COMP., TILT	1-F15	72	4
ARM FUEL PUMP ROCKER	1-C16	32	2
ARM STOPPER	1-E11	37	4
ARM STOPPER	1-D1	74	12
ARM THROTTLE REMOTE	1-F11	74	4
ARM VALVE ROCKER	1-C16	32	5

Page No.

2005.07.20 E

2000.09.20 E

Part catalogue structure

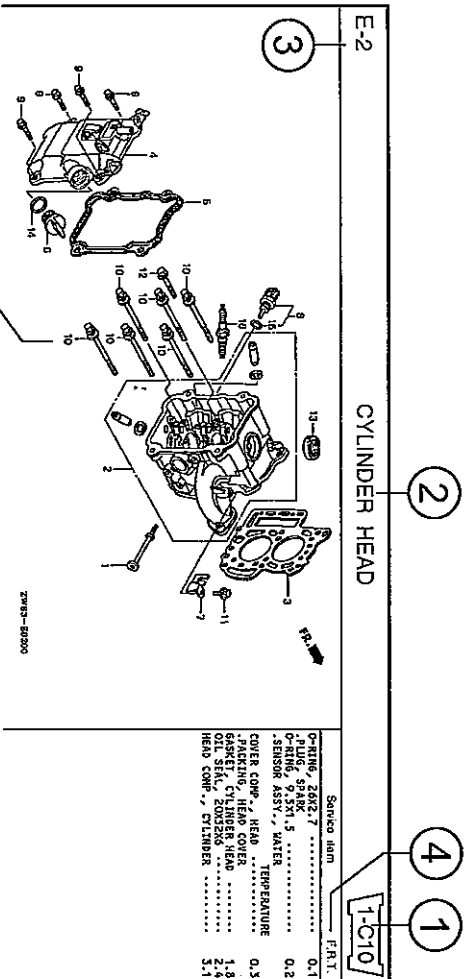

Part No.	Description	Req'd. QTY	Serial No.	Parts catalogue code
1	STOPPER, ENGINE SIDE	2		
2	HEAD COVER, CYLINDER	2		
3	GASKET, CYLINDER HEAD	1		
4	COVER COMP., HEAD	1		
5	PACKING, HEAD COVER	1		
6	CAP, OIL	1		
7	HOUSER, CABLE	1		

E-14-10

THROTTLE ROD

1-C10

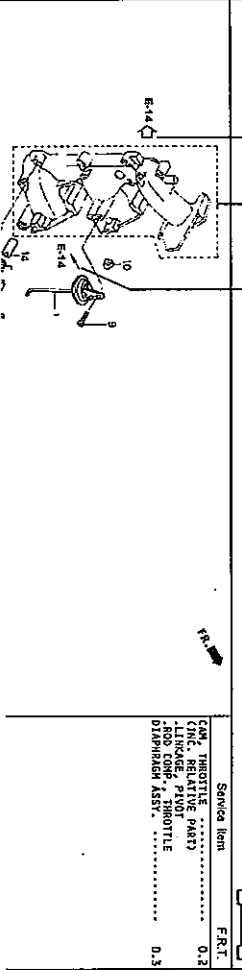

1 Address number

• Address No. is provided (in place of the page No.) to help you refer to the part with the part No. or part name.

2 Block title 3 Block number

4 Service item/Flat rate time

5 Reference number

• Title number marked with the parenthesis or parentheses indicates that it continues from the previous page.

6 Part number 7 Honda color code

8 Description

9 Assemblies

• Sections framed with broken lines in the exploded view drawings are available as complete assemblies. (Their individual parts can also be obtained.)

10 Color description

11 Note

• Notes are shown with the parentheses in the part name column.

12 Required quantity

• Required QTY shown in the parenthesis or parentheses indicates the optional part.

• Required QTY marked with "N" indicates the optional part that should be selected as needed.

• Required QTY indicates the number of the part used in the block.

13 Serial number

14 Type

• When the type column is blank, it indicates that the part is applicable to all types.

• As the type of the actual unit may differ from the "parts catalogue, type" please refer to "Models, types and applicable serial numbers" for confirmation.

• Parts enclosed within a dotted line are covered in a different block.

• A hollow arrow indicates the block No. for the parts enclosed within a dotted line.

• A solid arrow indicates the block No. the part in question is connected to.

When the parts were revised

Be sure to check the serial number!

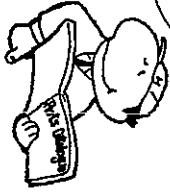

Ref. No.	Part No.	Description	Reqd. QTY										Serial No.
			902	901	1001	1001	1001	1001	1001	1001	1001	1001	
1	12166-219-000	STOPPER, ENGINE SIDE	2	2	2	2	2	2	2	2	2	2	
2	12210-219-000	HEAD COMP., CYLINDER	1	1	1	1	1	1	1	1	1	1	
3	12351-219-003	PISTON, CYLINDER	1	1	1	1	1	1	1	1	1	1	
4	12310-219-000	COVER, PISTON	1	1	1	1	1	1	1	1	1	1	
5	12312-219-000	PACKING, HEAD COVER	1	1	1	1	1	1	1	1	1	1	
6	15611-921-000	CAP., OIL	1	1	1	1	1	1	1	1	1	1	
7	16617-219-000	NO GAUGE	1	1	1	1	1	1	1	1	1	1	
	16617-219-010	HOLDER, CABLE (###)	1	1	1	1	1	1	1	1	1	1	

The number has been used from the initial model without revision. When shown at the left side, it is applicable to the models of No.1001801 and the up to No.1001800. When shown at the right side, it is applicable to the models subsequent numbers.

• The parts listed with "###" at the end of the parts name have limited supply period (parts not for sale).

Abbreviations used in the parts catalogue

• The following abbreviations are used in the parts name column.

- A Ampere
- A.C. Alternating current
- ASSY. Assembly
- AT. Automatic transmission
- C.D.I. Capacitive discharge ignition
- COMP. Complete
- D.C. Direct current
- EX. Exhaust
- G.F.C.I. Ground fault circuit interruptor
- HEX. Hexagonal
- H.S.T. Hydrostatic transmission
- FR. Front
- IN. Inlet
- L (100L) .Link (100 Links)
- L. Left
- MM Millimeter
- MT. Manual Transmission
- P.T.O. Power take off
- R. Right
- RR. Rear
- STD. Standard
- T (22T) ... Tooth (22 Teeth)
- V Volt
- W Watt

How to check the part block and serial numbers

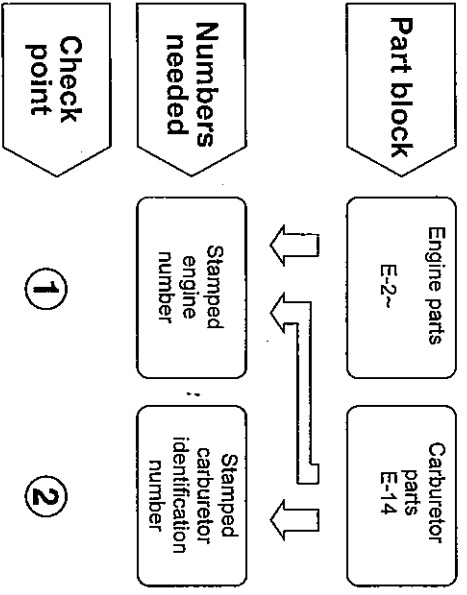

Check point

- ①
- ②

①
TYPE
ENGINE SERIAL NUMBER

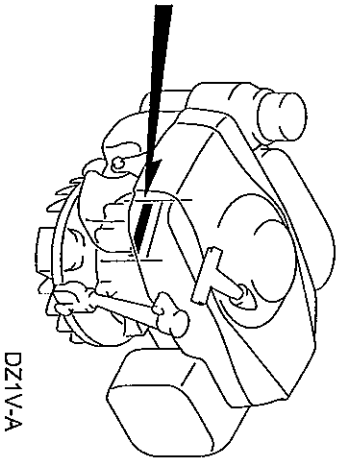

②-B
CARBURETOR
IDENTIFICATION NUMBER

②-A
CARBURETOR
IDENTIFICATION NUMBER

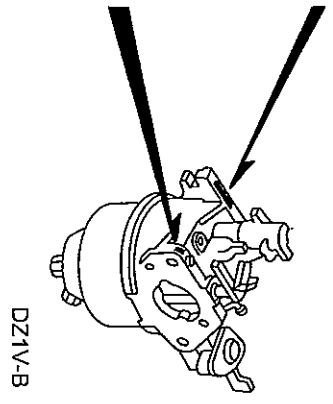

Models, parts catalogue codes and applicable serial numbers

• Models, parts catalogue codes and applicable serial Nos. given in this parts catalogue can be identified as follows.

Model	Type	Parts catalogue type	Applicable engine serial No.	Applicable carburetor identification No.
GXV160UH2	A1S	A1S	GJABH-1000001~	BE66J A
	A1SA	A1SA		
	A14	A14		
	N1	N1		
	N1F	N1F		
	N15	N15		
	N4	N4		
	N45	N45		BE66M A
	N5M	N5M		
	N55	N55		
	SFL	SFL		
	SFL1	SFL1		
	SFY	SFY		
	SFY1	SFY1		
T1AH	T1AH	BE66J A		

* Of carburetor identification numbers, only the portions underlined in the example below are used for registration.

BE 66J A KC †
 Ⓐ Ⓑ

Features of each type

• See the following table for the features of each type. (Items in brackets are optional)

Specifications		Model														
		A1S	A1SA	A14	N1	N1F	N1S	N4	N4S	NSM	NS5	SFL	SFL1	SFY	SFY1	T1AH
Crankshaft	22.2mmØ Straight	•	•	•	•	•	•									
	25.4mmØ Straight (Flat key-way)						•	•								
	25.4mmØ Straight									•						
	20mmØ Stepped thread										•					
Flywheel brake	5/8" Stepped thread															•
	M8 Tapered								•							

Fuel hose, general purpose hoses and vinyl hose

- The standard part fuel hose, general purpose hose and vinyl hose may be substituted by the called bulk part.
- When ordering the standard part fuel hose, general purpose hose and vinyl hose use the bulk part number written in the parts catalog in brackets () underneath the part name.
- When exchanging the hose, cut and use at the specified length as mentioned in the part name.
(For the method of cutting the bulk part, and method of filling out orders etc., please refer to the instructions issued with the bulk part.)

Bulk part number of fuel hose, general purpose hose and vinyl hose.

Example: 9 5 0 0 1 - 7 5 0 0 1 - 5 0 M

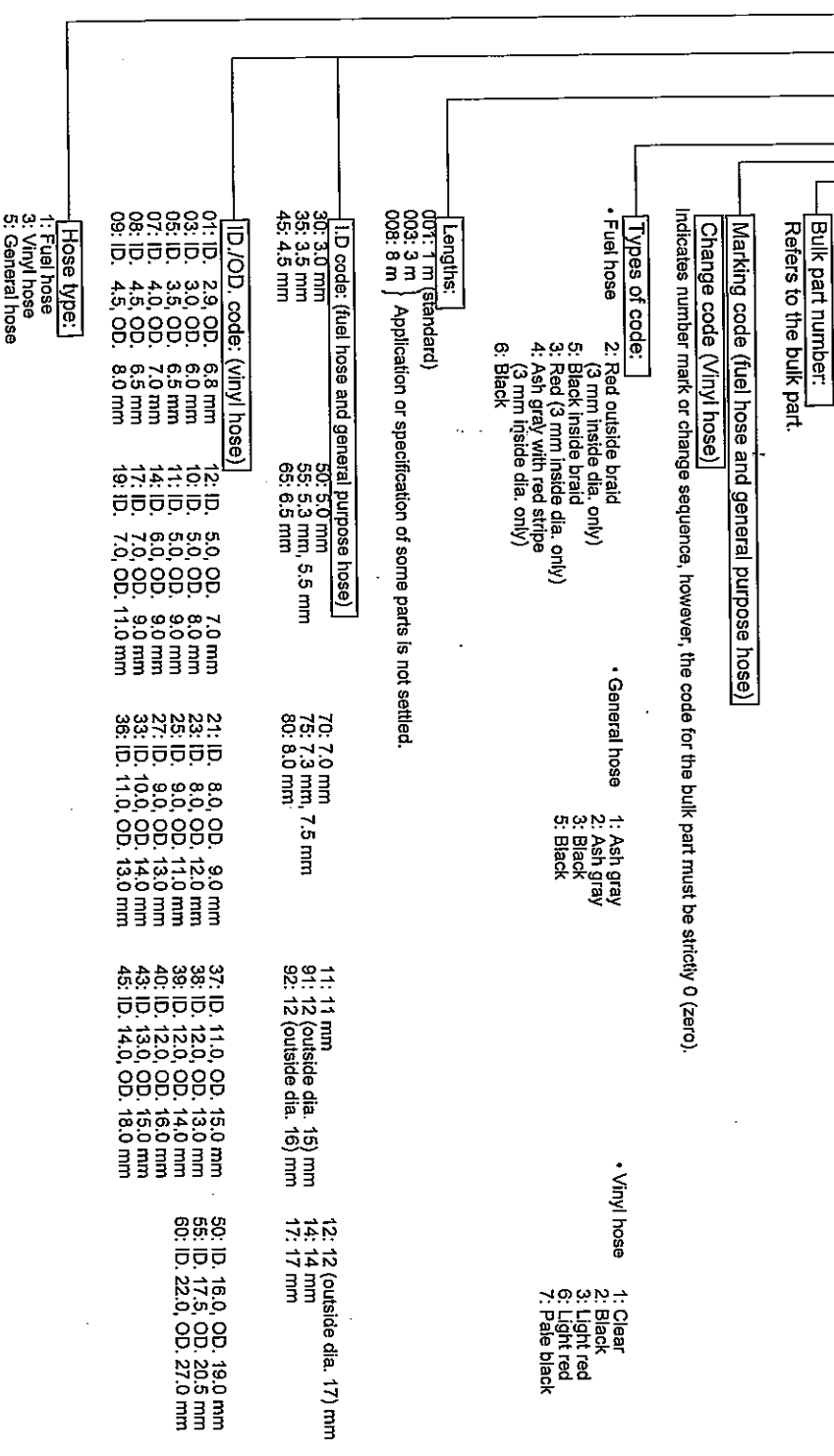

CAUTION: It is DANGEROUS to confuse the fuel hose with the general purpose hose or vinyl hose.
Never use a general purpose hose or vinyl hose in place of a fuel hose or vice versa. Always use the correct bulk part in the parts catalogue, according to the service manual or the instructions issued with the bulk part.

FLAT RATE SERVICE TIME

Flat rate service time (FRT) means the standard time required to service a product, which is listed in this manual to help the dealers control the actual working process and calculate the service charge by using it as a guide.

FRT setting system

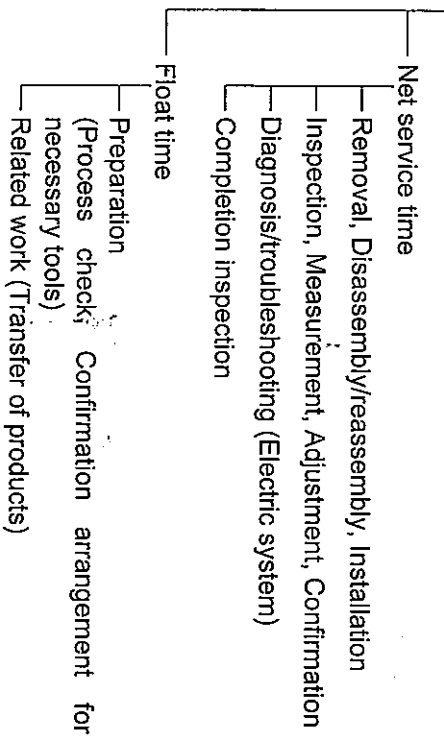

* Float time is set by multiplying the net service time by a given coefficient.

Editorial style

The service items shown in the text are listed with the exchange work time for the repair sales parts as the subject. Other representative service items not using repair parts (removal/installation, adjustment, inspection/measuring, and other work) are listed collectively in the list in the preface, classified according to the work.

FRT setting standard

- Decimal system (in unit of 0.1) is adopted to set FRT as it is convenient to calculate the wage.
Example: (0.1) → 6 minutes, (0.2) → 12 minutes
[Labor cost per hour] x [FRT] = [Wage]
- FRT is set with a hand tool.
- Service items and FRT can be subject to change depending on development of tools and service equipment and improvement in service procedure.

Work procedure

- As the work procedure is set with the work time according to the method in the separate Service Manual, refer to this Manual as required.
- Work methods permitting servicing in the shortest time still permitting assurance of safe work and product warranty are used for the setting of service items not listed in the Service Manual.
- Work basically is to be performed by one person, and when two or more people are required, setting is done as the total time for the number of people.
- The set value for the technological level of the workers uses a person with three years of experience in the repair of Honda products as the standard.
- Special tools and service equipment used to set FRT are those specified or recommended in Service Manual.

Service item whose FRT is not presented

- Accessories and service parts that are not listed to use in this manual.
- Locations with little aging deterioration or breakage during normal use.
- Service work that can be finished by one touch.
- Service work that is seldom done (i.e. extremely small causes of trouble and service frequency).
- Products and parts whose location for installation differs according to its status of use and application.
- * When FRT is not presented, please calculate wages based on appropriate actual work time.

Operation not included of FRT

- Oil and coolant water draining, Waiting time for warming up operation and etc..
- Additional operation that involves removal/installation of standard exterior equipment.
- Indirect time spent for service by visiting the customer, trade-in, and delivery.
- Indirect time required for ordering and delivery of parts.
- Cost for grease, adhesive agent, etc. used for service work.

Explanation of FRT by using an example
(The example may differ from the actual presented items)

Ref. No.	L.O.N.	(Relative ref. Number)	(F.R.T.)
1	1111L1	(1, 3, 4, 7)	2
2	1111L1	VALVE, INTAKE	4
3	1111L1A	NOTE: OHV type	6
		Includes: Engine removal and installation	7
		One head (intake all) add	5
	1,4	8

- ① Reference No. of the illustration of part that shows location of the replacement work.
- ② FRT is an abbreviation of Flat Rate Time indicating the standard service time required for the replacement.
- ③ LON is an abbreviation of Labor Operation Number, and it is a classification of the service items by the work unit code.
The same operation code is used regardless of the models.
Standard operation is indicated with 6 digits code, and additional operation is indicated with 7 digits code.
- ④ Indicating the intake valve replacement and FRT4.1.
- ⑤ Indicating FRT1.4 that will be added when additional operation (whole intake side of one cylinder head) is done in association with intake valve replacement.

⑥ Indicating work condition or application condition of the service item.

⑦ Indicating work contents that are included in the service item.

⑧ Indicating a reference No. whose operation and time are the same as FRT4.1 for the intake valve.

(The application range is limited to the service items without an LON setting within a same block.)

How to refer to the service item by using the sample
(intake valve replacement)

Open to the page of the block where the intake valve's spare part illustration is shown.



Look for the intake valve illustration, and refer to the service item and FRT that agree with the reference No.

Indication mark for the listing of service items that continues to the following page

Ref. No.	L.O.N.	(Relative ref. Number)	F.R.T.
2	1111L1	VALVE, INTAKE.....	4.1
	.	.	.
	.	.	.
	.	.	.

Mark indicated at the last line.

Indication of the block with no setting of FRT

Ref. No.	L.O.N.	(Relative ref. Number)	F.R.T.
		NO INFORMATION	

• LON code system

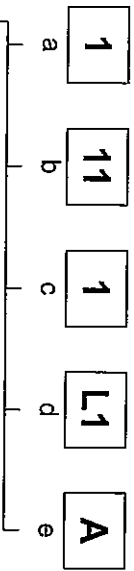

- a) Category code..... Engine
- b) Location/function code..... Engine upper
- c) Operation code..... Replace
- d) Operation sequence number (Unit code can be shown with alphabet)
..... Intake valve
..... (No regular rule of code)
- e) Additional code..... One head (Intake all)
..... (No regular rule of code)



a) Category codes and classification

Code	Category
1	Engine
2	Power drive
3	Fuel & Exhaust
4	Frame & Body
5	Steering
6	Electrical
7	Axle & Brake
8	Control system
9	-
0	Attachments

c) Operation codes and classification

Code	Operation category
1	Replace, Removal/Installation, Change
2	Overhaul
3	Adjust, Rotation
4	(Paint-related work: Top-coat)
5	Test, Inspect/diagnose, Measurement
6	(Overhaul-related work: Rebore)
7	(Overhaul-related work: Reseal)
8	(Resurface)
9	(Paint-related work: Refinish)
0	Repair, Cleaning, Air bleeding

Major service items without using spare parts

(1) Removal/Installation, (2) Adjustment, (3) Inspection/
Measurement, (4) Overhaul, (5) Other work

E: Engine, T: Transmission, D: Drive system, B: Body and related
parts

(1) Removal/Installation

Set with the parts configuration in the status of being removed from
the product.

LON	DESCRIPTION	FRT
E 1111L3	CYLINDER HEAD ASSEMBLY- REMOVAL/INSTALLATION	0.6

(2) Adjustment

LON	DESCRIPTION	FRT
1113A1	VALVE CLEARANCE-ADJUSTMENT NOTE: For 1 product	0.4
E 1163A0	CONTROL, THROTTLE/GOVERNOR- ADJUSTMENT	0.2
3113A2	CARBURETOR IDLE-ADJUSTMENT	0.1

(3) Inspection, Measurement, Cleaning

LON	DESCRIPTION	FRT
1105A0	ENGINE OIL-INSPECTION	0.1
3120A0	AIR CLEANER-CLEANING INCLUDES: Air cleaner-inspection	0.2
E 3130A0	SPARK ARRESTER-CLEANING	0.2
6140A0	SPARK PLUG-ADJUSTMENT/CLEANING NOTE: For 1 product	0.1

(4) Overhaul

Work condition: The required Measurements, inspections,
adjustments, and cleaning/washing of each part are performed,
including the main body removal/installation work and the
replacement of defective parts.

LON	DESCRIPTION	FRT
E 3112A0	CARBURETOR-OVERHAUL INCLUDES: All necessary adjustment	0.6

(5) Other work

LON	DESCRIPTION	FRT
E 1101E1	ENGINE OIL-CHANGE INCLUDES: Engine oil-inspection	0.1

ENGINE GROUP

B14

E-2
CYLINDER HEAD
C 1

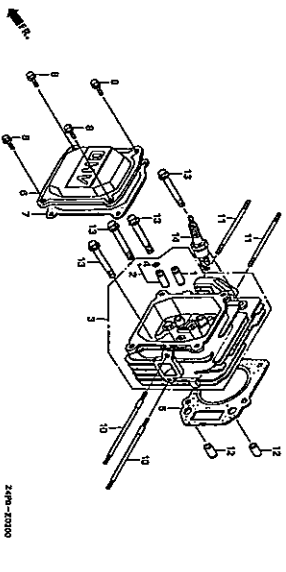

E-3
CYLINDER BARREL
C 2

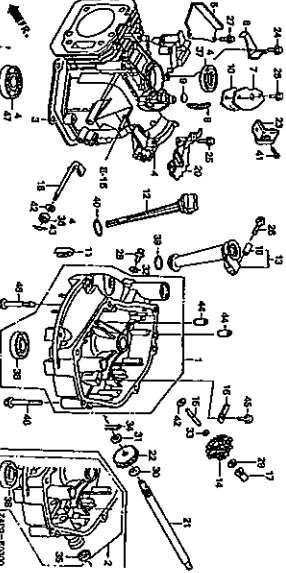

E-7
CRANKSHAFT/PISTON
C 5

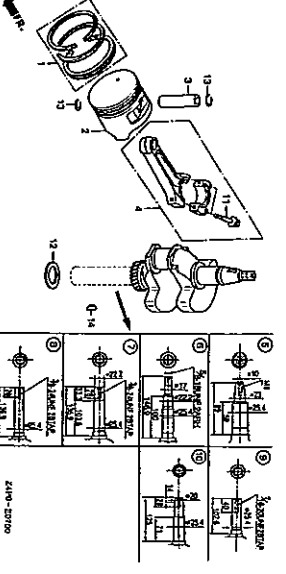

E-9
CAMSHAFT
C 7

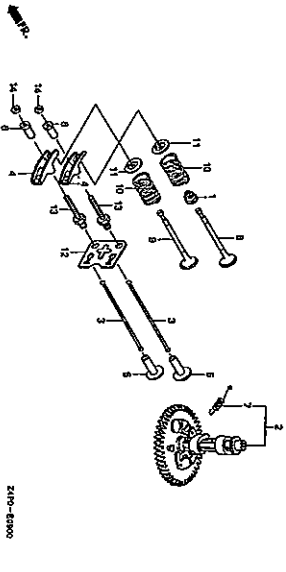

E-11
RECOIL STARTER
C 10

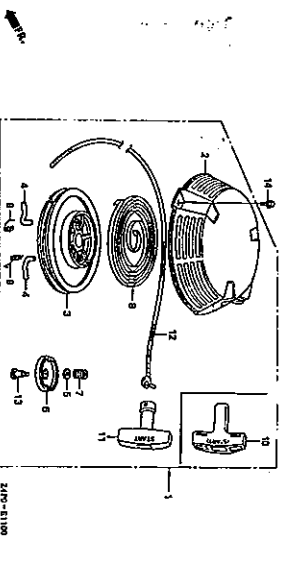

E-12
FAN COVER
C 11

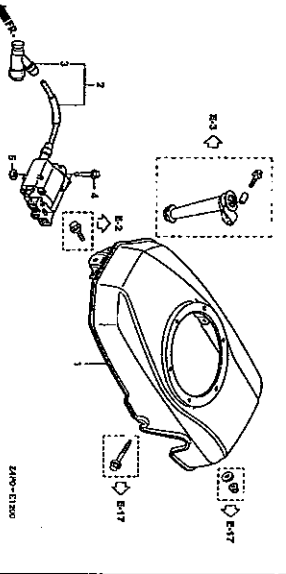

E-14
CARBURETOR
C 12

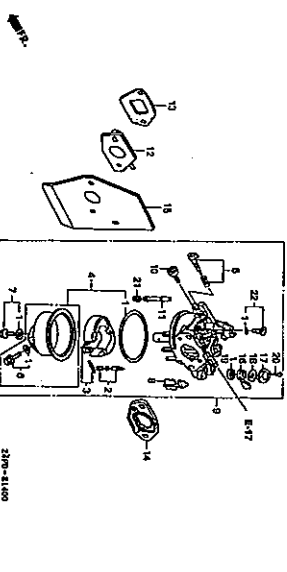

E-15
AIR CLEANER
C 14

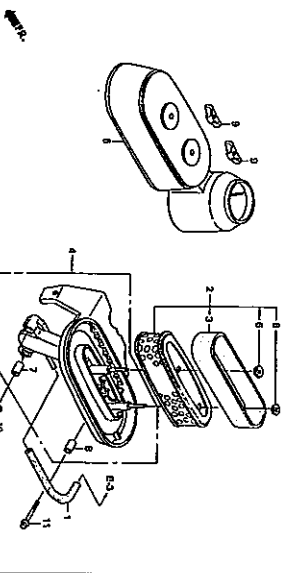

E-16
MUFFLER
C 15

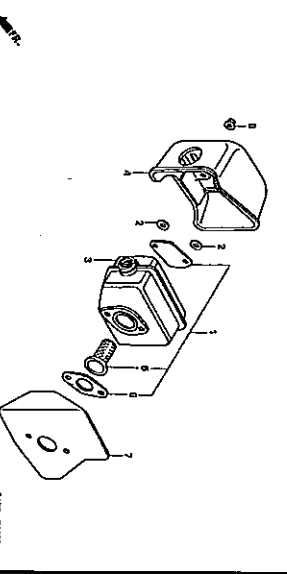

ENGINE GROUP

B15

E-17 FUEL TANK
C16

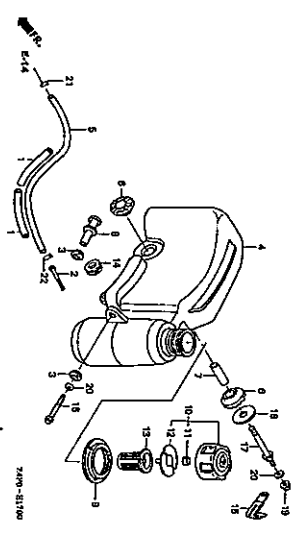

E-19 FLYWHEEL(1)
D1

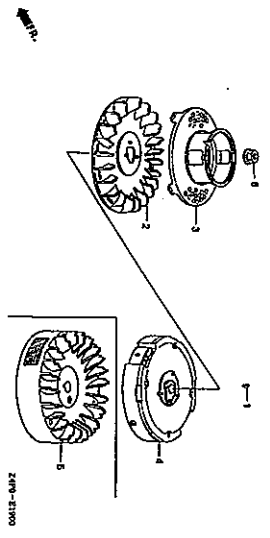

E-19-1 FLYWHEEL(2)
D2

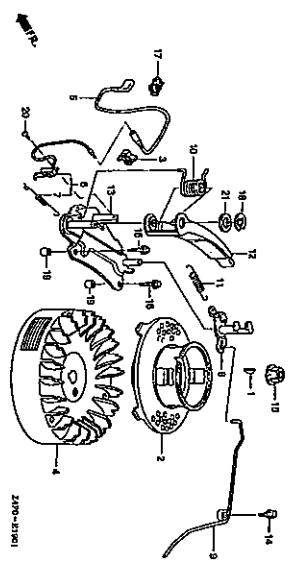

E-22 CONTROL(1)
D3

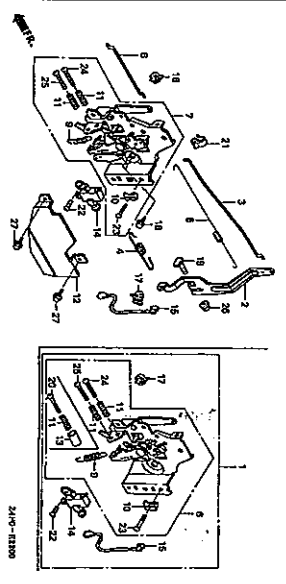

E-22-1 CONTROL(2)
D5

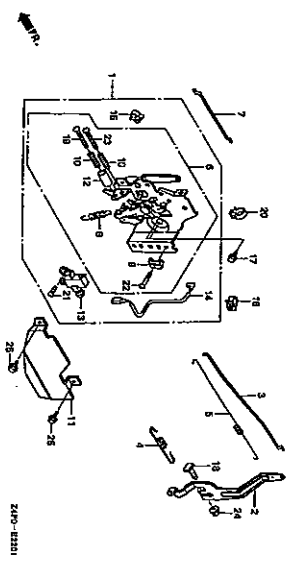

E-28 LABEL/TOOL
D6

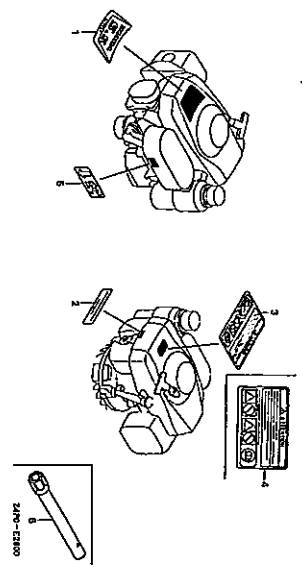

E-40 BLADE HOLDER
D7

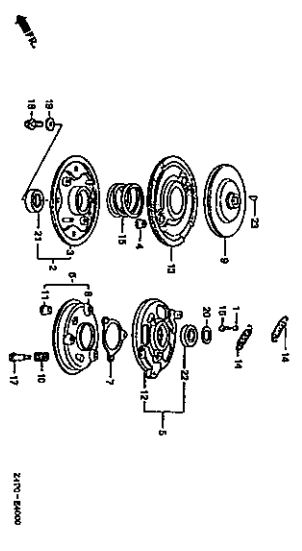

CYLINDER HEAD

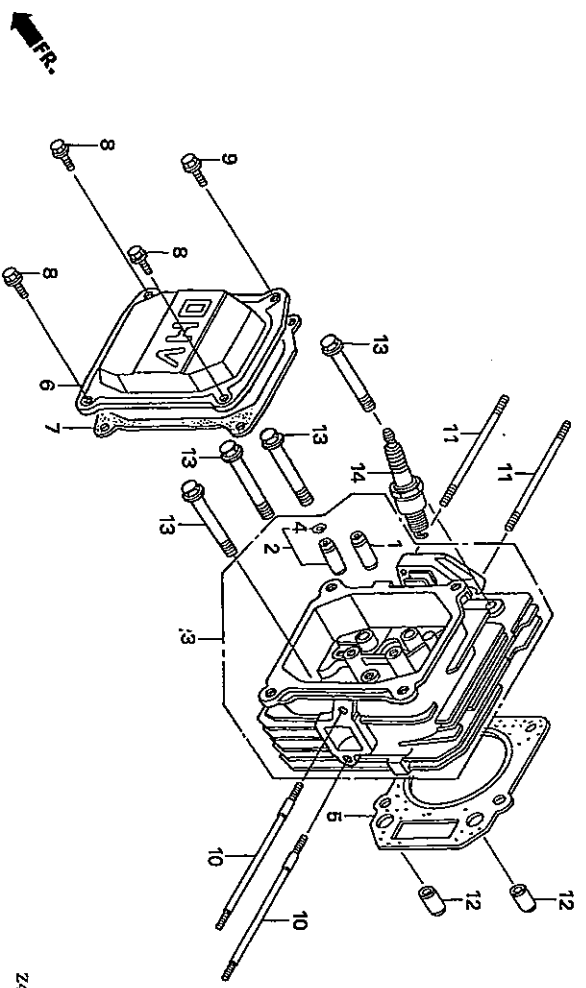

Z4P0-3E0200

Ref. No.	Part No.	Description	Reqd. QTY :gxy :hp :UH2	Serial No.	Parts catalogue code
----------	----------	-------------	----------------------------------	------------	----------------------

1	12204-ZE1-306	GUIDE, IN. VALVE (O.S.)	(1)		1 1111E9	GUIDE, INTAKE VALVE	0.8
2	12205-ZE1-315	GUIDE, EX. VALVE (O.S.)	(1)		1111E9E	.INCLUDES: Valve clearance adjustment	
3	12210-Z1V-000	HEAD COMP., CYLINDER	1		2 1111E8	.Replace intake and exhaust all add	0.2
4	12216-ZE5-300	CLIP, VALVE GUIDE	1			.INCLUDES: Valve clearance adjustment	0.8
5	12251-ZE7-000	GASKET, CYLINDER HEAD	1		1111E8E	.Replace intake and exhaust all add	0.2
6	12311-Z69-800	COVER, HEAD	1		3 1111N3	HEAD, CYLINDER	1.0
7	12391-ZE7-M10	PACKING, HEAD COVER	1			.INCLUDES: Valve clearance adjustment and reface	
8	90013-883-000	BOLT, FLANGE, 6X12(CT200)	3		5 1111N4	GASKET, CYLINDER HEAD	0.6
9	90014-952-000	BOLT, FLANGE, 6X14(CT200)	1		6 1111D5	COVER, CYLINDER HEAD AND/OR PACKING, HEAD COVER	0.1
10	90043-ZE6-000	BOLT, STUD, 6X109	2		14 6141C1	PLUG, SPARK	0.1
11	90048-ZC3-000	BOLT, STUD, 6X85	2			.INCLUDES: Spark plug check	
12	94301-10160	DOWEL PIN, 10X16	2				
13	95701-08050-00	BOLT, FLANGE, 8X50	4				
14	98079-54846	PLUG, SPARK (BPR4ES) (NGK)	4				
	98079-54855	PLUG, SPARK (W14EPR-U) (DENSO)	(1)				
	98079-55846	PLUG, SPARK (BPR5ES) (NGK)	1				
	98079-55855	PLUG, SPARK (W16EPR-U) (DENSO)	1				
	98079-56846	PLUG, SPARK (BPR6ES) (NGK)	(1)				
	98079-56855	PLUG, SPARK (W20EPR-U) (DENSO)	(1)				

Z4P0-3E0200



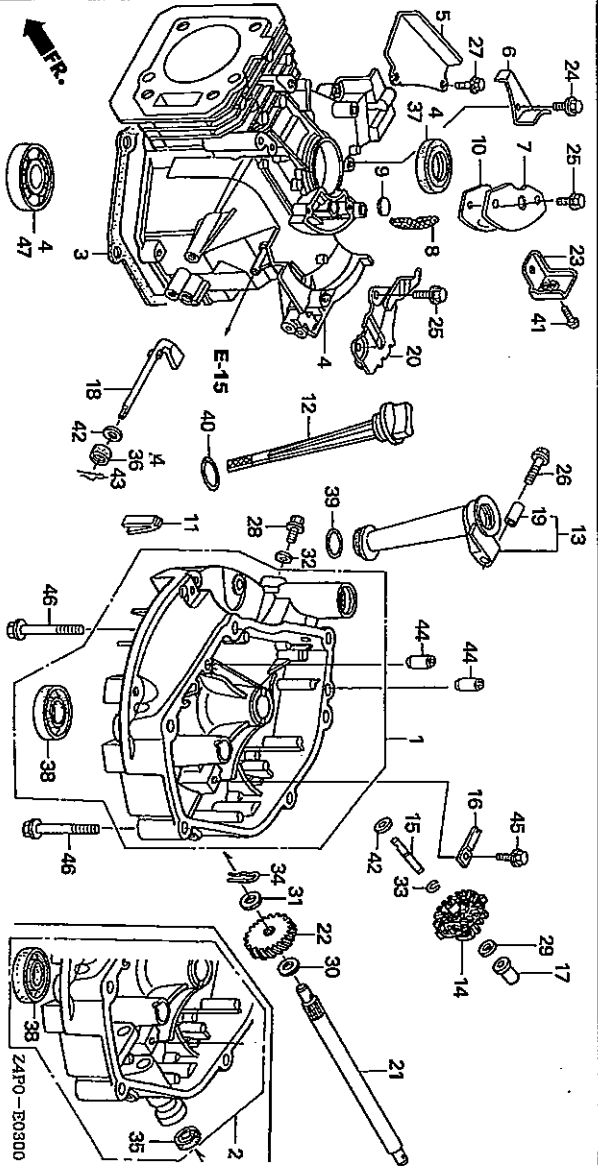

Ref. No.	Part No.	Description	Reqd. QTY	Serial No.	Parts catalogue code
1	11300-Z1V-U90	PAN ASSY., OIL	1	NSM	11300-Z1V-U90
	11300-Z1V-V50	1	SFY	11300-Z1V-V50
	11300-Z1V-000	1	A1S,A1SA,A14,N1,N1F,N15,N4,N45,N55,T1AH	11300-Z1V-000
2	11300-Z1V-800	PAN ASSY., OIL	1	SFL,SFL1,SFY1	11300-Z1V-800
3	11381-ZE7-M10	PACKING, OIL PAN	1	A1S,A1SA,A14	11381-ZE7-M10
4	12000-Z1V-000	BARREL ASSY., CYLINDER	1	N1,N1F,N15,N4,N45,N5M,N55,SFL,SFL1,SFY,SFY1,T1AH	12000-Z1V-000
5	12125-Z1V-000	PLATE, GUIDE	1	N1,N1F,N15,N4,N45,N5M,N55,SFL,SFL1,SFY,SFY1,T1AH	12125-Z1V-000
6	12126-Z1V-000	PLATE A, GUIDE	1	N1,N1F,N15,N4,N45,N5M,N55,SFL,SFL1,SFY,SFY1,T1AH	12126-Z1V-000
7	12355-Z1V-800	COVER COMP., BREATHER	1	A1S,A1SA,A14	12355-Z1V-800
8	12367-883-003	FILTER, BREATHER	1		12367-883-003
9	12372-ZE7-000	VALVE, BREATHER	1		12372-ZE7-000
10	12373-ZE7-000	PACKING, BREATHER COVER	1		12373-ZE7-000
11	15335-ZE7-000	RUBBER, OIL RETURN	1		15335-ZE7-000
12	15620-ZE6-810	GAUGE COMP., OIL LEVEL	1		15620-ZE6-810
13	15630-ZE6-810	EXTENSION, OIL FILLER	1		15630-ZE6-810
14	16510-ZE6-000	GOVERNOR ASSY.	1		16510-ZE6-000
15	16515-ZE6-010	SHAFT, GOVERNOR HOLDER	1		16515-ZE6-010
16	16525-ZE6-010	PLATE, GOVERNOR SHAFT HOLDER	1		16525-ZE6-010
17	16531-Z1T-000	SLIDER, GOVERNOR	1		16531-Z1T-000
18	16541-ZE7-000	SHAFT, GOVERNOR ARM	1		16541-ZE7-000
19	17240-ZE6-000	COLLAR, EXTENSION	1		17240-ZE6-000
20	17560-Z1V-000	STAY COMP., TANK	1		17560-Z1V-000
21	23411-ZE7-000	SHAFT, DRIVE	1	SFL,SFL1,SFY1	23411-ZE7-000

Ref. No.	L.O.N.	(Relative ref. Number)	Description	F.R.T.
1	1131C1	(2)	PAN, OIL	0.3
3	1131C2		PACKING, OIL PAN	0.3
4	1101A0		BARREL, CYLINDER	1.5
7	1111D1		COVER, BREATHER AND/OR	0.2
8	1111E5		PACKING, BREATHER COVER	0.2
9	1111K9		FILTER, BREATHER	0.2
13	1101B9		VALVE, BREATHER	0.2
14	1161C4		EXTENSION, OIL FILLER AND/OR	0.1
17	1161B6		PACKING, OIL FILLER EXTENSION	0.4
18	1161B4		GOVERNOR ASSEMBLY	0.4
21	2131J5		SLIDER, GOVERNOR	0.3
22	2131D5		SHAFT, GOVERNOR ARM	0.3
36	1101C4		SHAFT, DRIVE	0.3
37	1101E6		GEAR, DRIVEN	0.3
38	1101E7		OIL SEAL, GOVERNOR ARM SHAFT	0.3
47	1101J6		OIL SEAL, CRANKSHAFT : UPPER	1.1
			OIL SEAL, CRANKSHAFT : LOWER	0.3
			BEARING, CRANKSHAFT : UPPER	1.2



E-3

CYLINDER BARREL

C 3

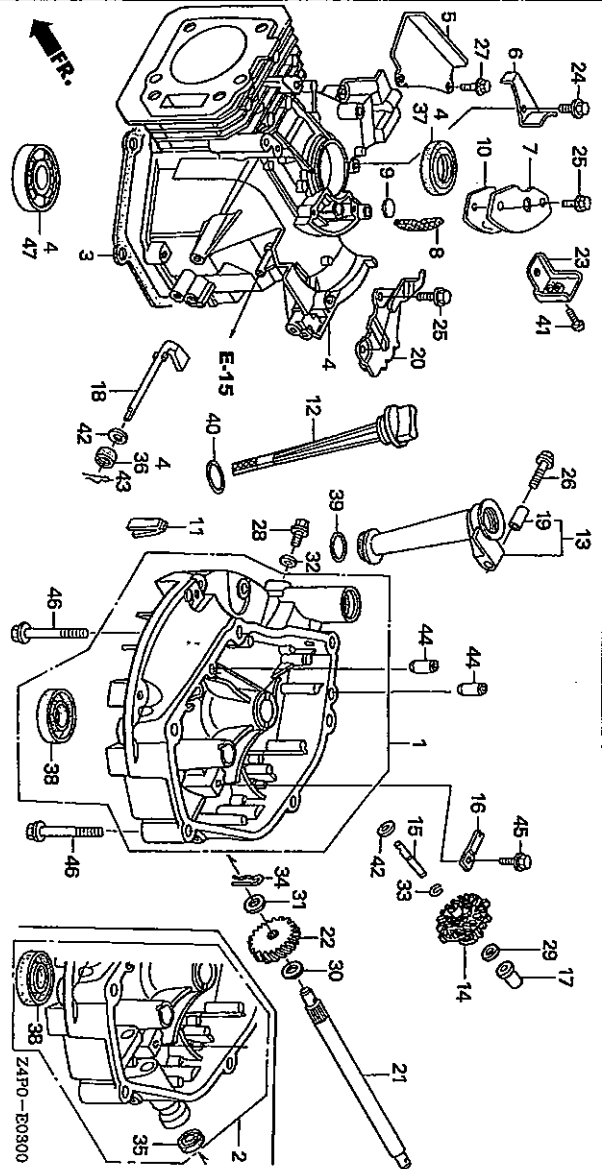

Ref. No.	Part No.	Description	Reqd. QTY	Serial No.	Parts catalogue code
22	23421-ZE6-000	GEAR, DRIVEN (18T)	1		
23	43143-Z1V-000	BASE COMP., HOLDER	1		SFL,SFL1,SFY1
24	900T3-883-000	BOLT, FLANGE, 6X12(CT200)	1		A1S,A1SA,A14
25	90014-952-000	BOLT, FLANGE, 6X14(CT200)	4		
26	90017-883-000	BOLT, FLANGE, 6X32	1		
27	90022-888-010	BOLT, FLANGE, 6X20(CT200)	2		
28	90T31-ZE1-000	BOLT, DRAIN PLUG	1		N1,N1F,N15,N4,N45,N5M,N55,SFL,SFL1,SFY,T1AH
29	90451-ZE1-000	WASHER, THRUST, 6MM	1		
30	90452-166-600	WASHER, THRUST, 12MM	1		SFL,SFL1,SFY1
31	90452-187-000	WASHER, 10X21	1		SFL,SFL1,SFY1
32	90601-ZE1-000	WASHER, DRAIN PLUG, 10.2MM	1		
33	90602-ZE1-000	CLIP, GOVERNOR HOLDER	1		
34	90701-ZE6-000	PIN, LOCK, 2.0	1		SFL,SFL1,SFY1
35	91205-Z1V-003	OIL SEAL, 12X20X6.5	1		SFL,SFL1,SFY1
36	91231-Z1V-003	OIL SEAL, 6X11X4	1		
37	91251-Z1V-003	OIL SEAL, 25X38X7	1		
38	91252-Z1V-003	OIL SEAL, 25.4X40X7	1		
39	91301-Z1V-003	O-RING, 22.1X2.2	1		
40	91302-Z1V-003	O-RING, 25.5X3	1		
41	93500-05016-0A	SCREW, PAN, 5X16	1		A1S,A1SA,A14
42	94101-06800	WASHER, PLAIN, 6MM	2		
43	94251-08000	PIN, LOCK, 8MM	1		
44	94301-08140	DOWEL PIN, 8X14	2		
45	95701-06012-08	BOLT, FLANGE, 6X12	1		

E-3

CYLINDER BARREL

C 4

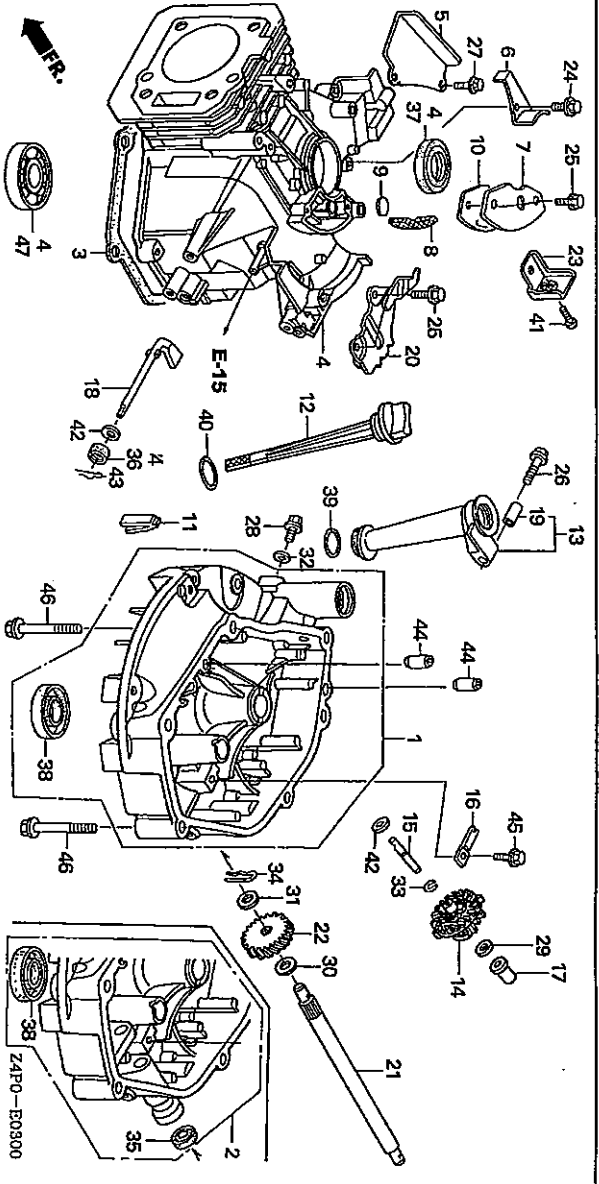

Ref. No.	Part No.	Description	Reqd. QTY	Serial No.	Parts catalogue code
46	95701-08050-00	BOLT, FLANGE, 8X50	6		
47	96100-62050-00	BEARING, RADIAL BALL, 6205 ...	1		

GXY 180
 UH2
 19



CRANKSHAFT/PISTON

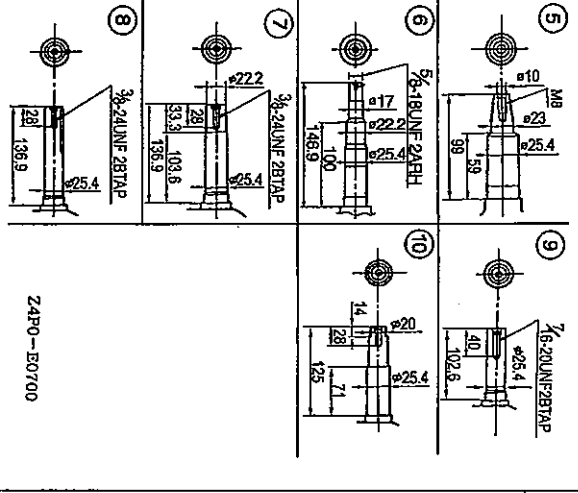
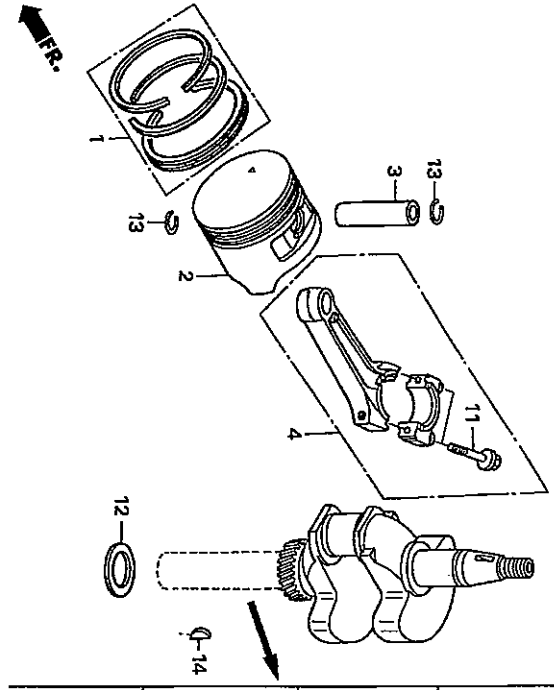

Ref. L.O.N. (Relative ref. Number) F.R.T.
No. Description

2 1111R1 (1, 2, 4) PISTON AND/OR RING SET AND/OR BEARING AND/OR ROD 1.2
INCLUDES: Inspection/ Measurement/Cleaning (6, 7, 8, 9, 10)
5 1101F0 CRANKSHAFT 1.1

Ref. No.	Part No.	Description	Reqd. QTY : gxy : 160 : UH2	Serial No.	Parts catalogue code
----------	----------	-------------	--------------------------------------	------------	----------------------

1	13010-ZL0-003	RING SET, PISTON (STD.) (TEIKOKU)	1		
	13010-ZL0-004	RING SET, PISTON (STD.) (NIPPON)	1		
	13011-ZL0-003	RING SET, PISTON (O.25) (TEIKOKU)	(1)		
	13011-ZL0-004	RING SET, PISTON (O.25) (NIPPON)	(1)		
	13012-ZL0-003	RING SET, PISTON (O.50) (TEIKOKU)	(1)		
	13012-ZL0-004	RING SET, PISTON (O.50) (NIPPON)	(1)		
	13013-ZL0-003	RING SET, PISTON (O.75) (TEIKOKU)	(1)		
	13013-ZL0-004	RING SET, PISTON (O.75) (NIPPON)	(1)		
2	13101-Z11T-000	PISTON (STD.) (JIALING-HONDA)	1		
	13102-ZE7-020	PISTON (O.25) (NIPPON)	(1)		
	13103-ZE7-020	PISTON (O.50) (NIPPON)	(1)		
	13104-ZE7-020	PISTON (O.75) (NIPPON)	(1)		
	13111-Z11T-000	PIN, PISTON	1		
	13200-Z1V-000	ROD ASSY	1		
	13310-ZE7-U41	CRANKSHAFT COMP.	1		NSM
6	13310-ZE7-V20	CRANKSHAFT COMP.	1		T1AH
7	13310-ZE7-O10	CRANKSHAFT COMP.	1		A1S, A1SA, A14, N1, N1F, N15
8	13310-ZE7-641	CRANKSHAFT COMP.	1		N4, N45
9	13310-ZE7-661	CRANKSHAFT COMP.	1		N5
10	13310-ZE7-771	CRANKSHAFT COMP.	1		SFL, SFL1, SFV, SFY1

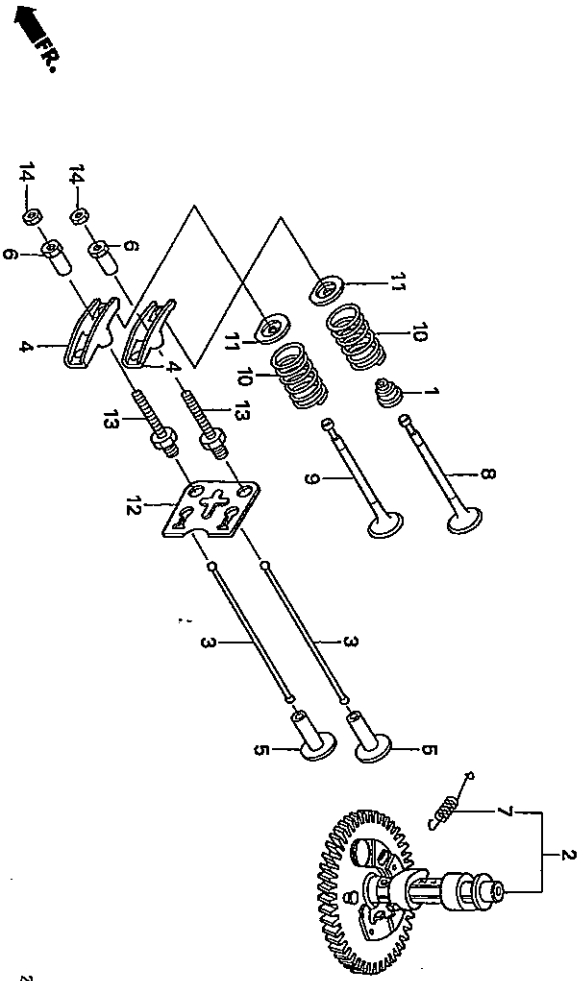

Z4P0-30900

Ref. No.	Part No.	Description	Reqd. QTY	Serial No.	Parts catalogue code
1	12209-ZE6-003	SEAL, VALVE STEM	1		
2	14100-ZE7-000	CAMSHAFT ASSY.	1		
	14100-ZE7-770				A1S, A1SA, A14, N1, N1F, N15, N4, N45, N5M, N55, T1AH
3	14410-ZE1-010	ROD, PUSH	2		SFL, SFL1, SFY, SFY1
4	14431-ZE1-000	ARM, VALVE ROCKER	2		
5	14441-ZE1-010	LIFTER, VALVE	2		
6	14451-ZE1-013	PIVOT, ROCKER ARM	2		
7	14568-ZE1-000	SPRING, WEIGHT RETURN	1		
8	14711-ZF1-000	VALVE, IN.	1		
9	14721-ZE7-000	VALVE, EX.	1		
10	14751-ZE1-000	SPRING, VALVE	2		
11	14771-ZE1-000	RETAINER, IN. VALVE SPRING	2		
12	14791-ZE1-010	PLATE, PUSH ROD GUIDE	1		
13	90012-ZE0-010	BOLT, PIVOT, 8MM	2		
14	90206-ZE1-000	NUT, PIVOT ADJUSTING	2		

Ref. No.	L.O.N.	(Relative ref. Number)	Description	F.R.T.
1	1111K2		SEAL, INTAKE VALVE STEM	0.6
			.INCLUDES: Valve clearance adjustment	
2	1111C2		CAMSHAFT	0.6
			.INCLUDES: Valve clearance adjustment	
3	1111L6		ROD, PUSH :INTAKE	0.2
			.INCLUDES: Valve clearance adjustment	
	1111L6A		.Replace exhaust push rod add	0.1
	1111L7		ROD, PUSH :EXHAUST	0.2
			.INCLUDES: Valve clearance adjustment	
	1111L7A		.Replace intake push rod add	0.1
4	1111A2		ARM, ROCKER :INTAKE	0.2
			.INCLUDES: Valve clearance adjustment	
	1111A2A		.Replace exhaust rocker arm add	0.1
	1111A1		ARM, ROCKER :EXHAUST	0.2
			.INCLUDES: Valve clearance adjustment	
	1111A1A		.Replace intake rocker arm add	0.1
5	1111L9		LIFTER, VALVE :INTAKE	0.6
			.NOTE: Same time for two units	

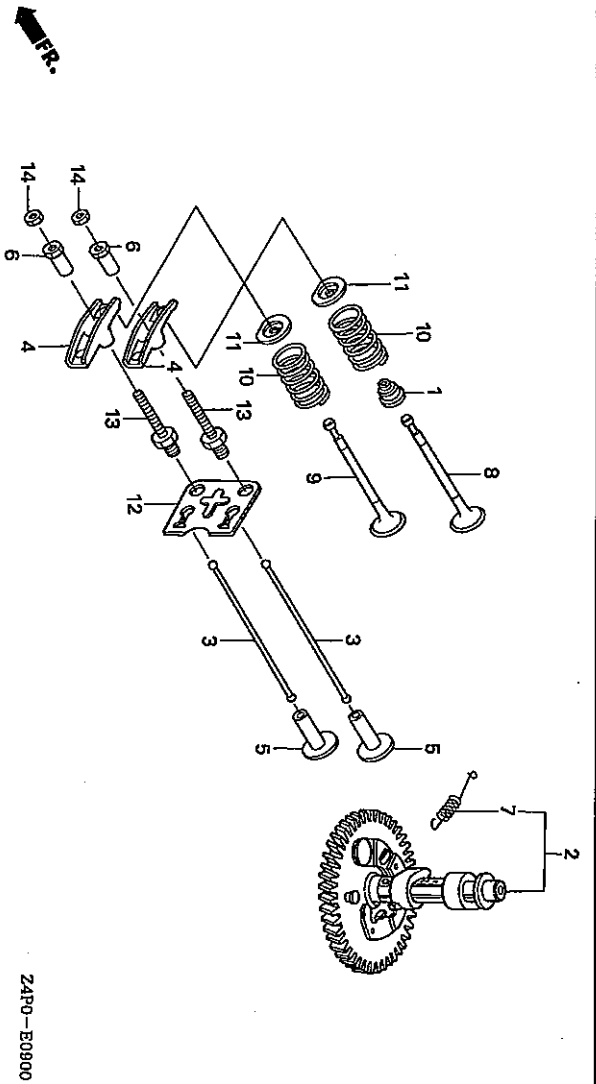

ZAP0-B0900

Ref. No.	L.O.N. (Relative ref. Number)	Description	F.R.T.
+ 5		. INCLUDES: Valve clearance adjustment	
1111W0		LIFTER, VALVE :EXHAUST	0.6
		. NOTE: Same time for two units	
		. INCLUDES: Valve clearance adjustment	
8 1111L1		VALVE, INTAKE	0.7
		. INCLUDES: Valve clearance adjustment and reface	
1111L1E		VALVE, EXHAUST	0.1
		all add	
9 1111L0		VALVE, EXHAUST	0.7
		. INCLUDES: Valve clearance adjustment and reface	
1111L0E		VALVE, INTAKE	0.1
		all add	
10 1111P3		SPRING, VALVE :INTAKE	0.6
		. INCLUDES: Valve clearance adjustment	
1111P3A		SPRING, VALVE :EXHAUST	0.1
		all add	
1111P4		SPRING, VALVE :EXHAUST	0.6
		. INCLUDES: Valve clearance adjustment	



E-9

CAMSHAFT

C 9

Ref. No.	L.O.N. (Relative ref. Number)	Description	F.R.T.
+10	1111P4A	-Replace intake and exhaust all add	0.1

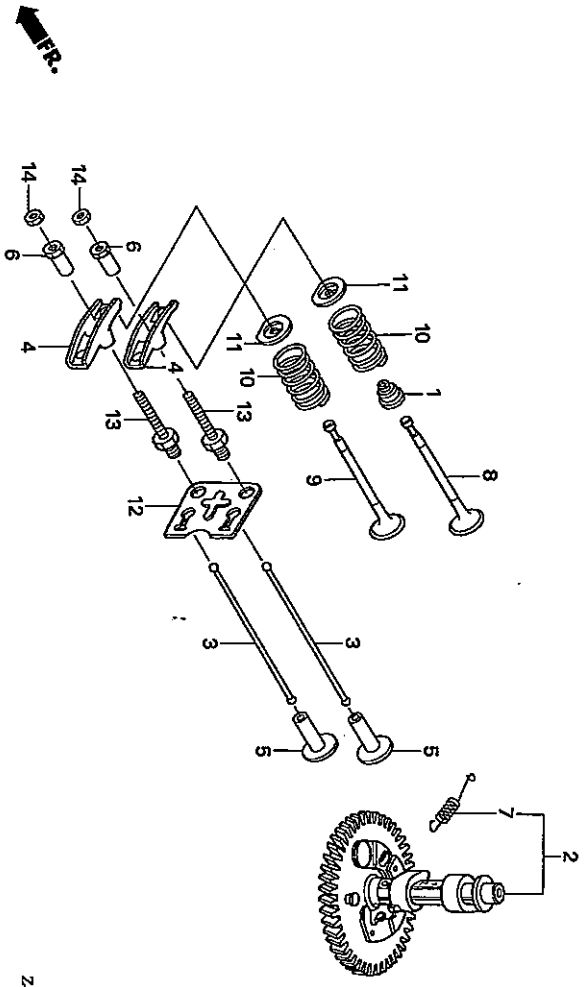

ZAP0-E0900

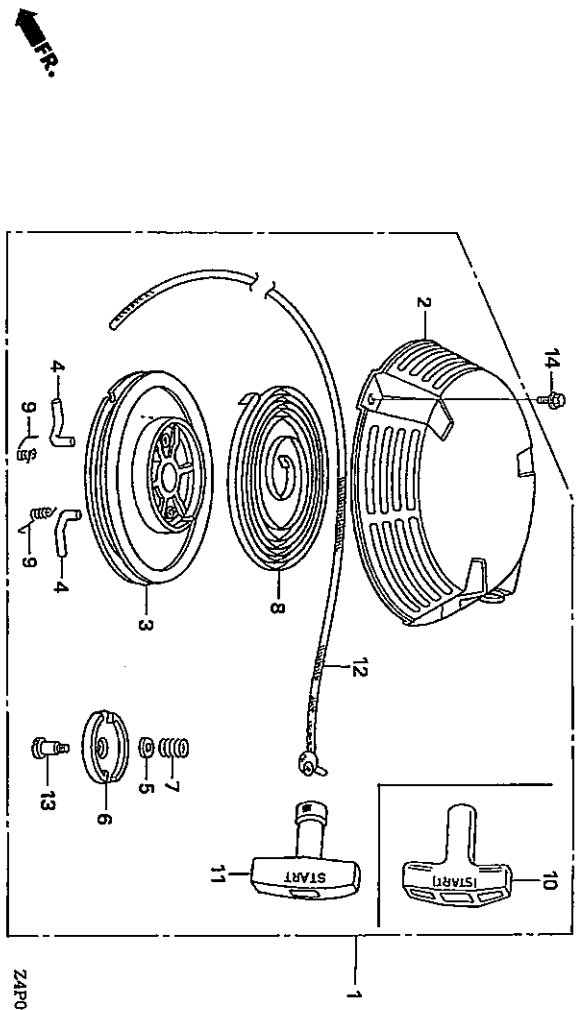

Ref. No.	L.O.N.	(Relative ref Number)	Description	F.R.T.
1	1121B9		STARTER, RECOIL	0.1
3	1121B1		REEL, RECOIL STARTER	0.3
4	1121B0		RATCHET, STARTER AND/OR SPRING, RATCHET	0.2
6			NOTE: Same time for two units (7)	
8	1121A4		GUIDE, RATCHET	0.2
10	1121B7		SPRING, RECOIL STARTER RETURN	0.3
12	1121A3		GRIP, RECOIL STARTER	0.1
12	1121B5		ROPE, RECOIL STARTER	0.3

Ref. No.	Part No.	Description	Reqd. QTY	Serial No.	Parts catalogue code
			GXV		
			180		
			UH2		
1	28400-Z1V-003ZA	STARTER ASSY., RECOIL	1	SFL1, T1AH	
		NH1			
		BLACK			
28400-Z1V-003ZB		*R280*	1	N1, N4, SFL, SFY1	
		POWER RED			
28400-Z1V-801ZA		STARTER ASSY., RECOIL	1		
		(LONG ROPE)			
		NH1			
		BLACK			
28400-Z1V-801ZB		*R280*	1	A1S, A1SA, A14, N1F, N15, N45, N5M, N55	
		CASE COMP., RECOIL STARTER	1	A1S, A1SA, A14, N1F, N15, N45, N5M, N55	
2	28410-Z1V-003ZA	POWER STARTER	1		
		R280			
		POWER RED			
28410-Z1V-003ZB		POWER STARTER	1	A1S, A1SA, A14, N1, N1F, N15, N4, N45, N5M, N55, SFL, SFY1	
		NH1			
		BLACK			
3	28420-Z1V-003	REEL, RECOIL STARTER (BLACK)	1		
4	28422-ZH8-801	RATCHET, STARTER	1		
5	28431-ZH8-801	PLATE, FRICTION	1		
6	28433-ZH8-801	GUIDE, RATCHET	1		
7	28441-ZH8-801	SPRING, FRICTION	1		
8	28442-ZH8-003	SPRING, RECOIL STARTER	1		
9	28443-ZH8-801	SPRING, RETURN	2		
10	28461-ZE1-003	KNOB, RECOIL STARTER	1	A1S, A1SA, A14, N1F, N15, N45, N5M, N55	
11	28461-ZH8-003	GRIP, STARTER	1		
12	28462-ZH8-003	ROPE, RECOIL STARTER	1	N1, N4, SFL, SFY1, T1AH	
		(LONG)			
28462-Z1V-801		ROPE, RECOIL STARTER	1		
		(236QMM)			
13	90003-ZH8-801	SCREW, SETTING	1	A1S, A1SA, A14, N1F, N15, N45, N5M, N55	
14	95701-06008-00	BOLT, FLANGE, 6X8	3		

E-12

FAN COVER

C11

Ref. No.	L.O.N.	(Relative ref. Number)	Description	F.R.T.
1	114168		COVER, ENGINE COOLING FAN	0.2
2	6141A5		COIL, IGNITION(ONE)	0.2
3	6141B8		TERMINAL, HIGH TENSION	0.1

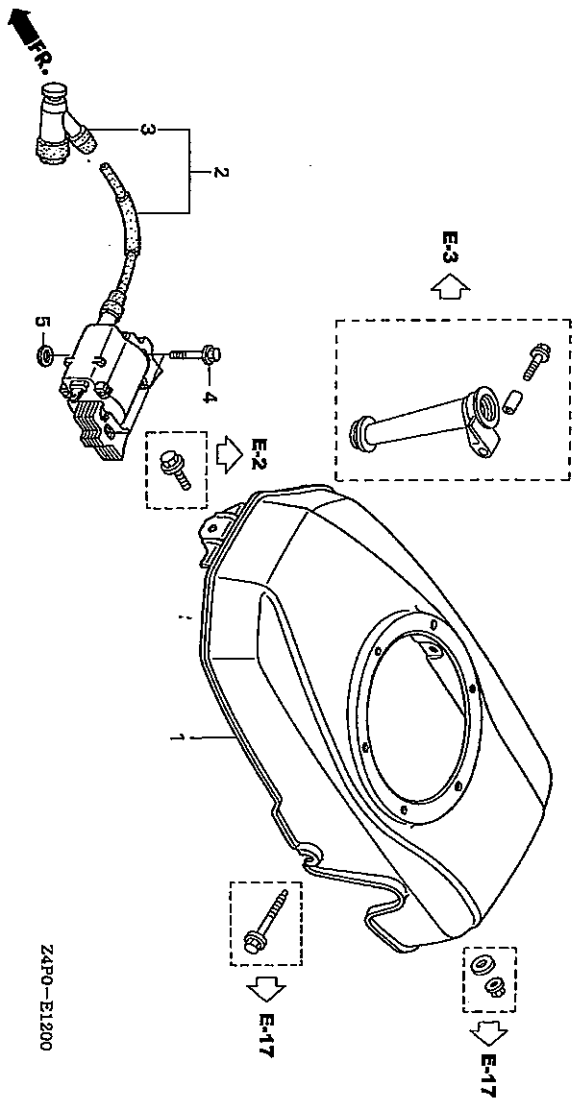

Ref. No.	Part No.	Description	Reqd. QTY : gvx : 160 UH2	Serial No.	Parts catalogue code
----------	----------	-------------	------------------------------------	------------	----------------------

- 1 19610-21V-000ZA COVER COMP., FAN *R280*.....POWER RED 1
- 19610-21V-000ZB *NH1*.....BLACK 1
- 2 30500-21V-003 COIL ASSY., IGNITIONBLACK 1
- 3 30700-21V-003 CAP ASSY., NOISE SUPPRESSOR 1
- 4 90015-883-000 BOLT, FLANGE, 6X28 2
- 5 90581-21V-000 WASHER, PLAIN, 6MM 2

A1S, A1SA, A14, N1, N1F, N15, N4, N45, N5M, N55, SFL, SFL1, SFY, SFY1
A1S, A1SA, A14, N1F, N15, N45, N5M, N55, SFL1, TTAH

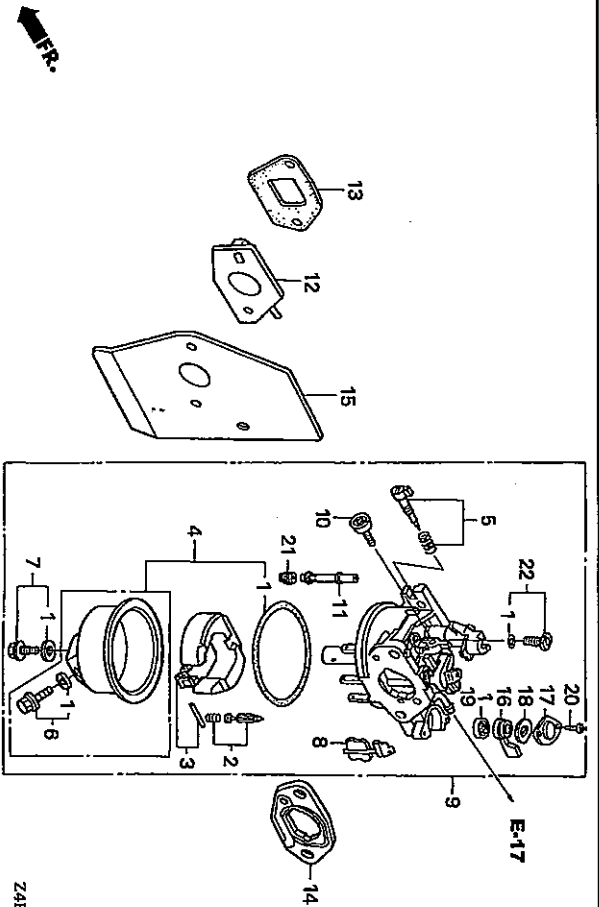

Z4P0-E1400

Ref. No.	Part No.	Description	Reqd. QTY gxy 180 UH2	Serial No.	Parts catalogue code	Ref. No. L.O.N. (Relative ref. Number)	Description	F.R.T.
1	16010-ZEO-025	GASKET SET	1			1 3111B1	GASKET SET, CARBURETOR	0.3
2	16011-ZEO-005	VALVE SET, FLOAT	1			2 3111E1	VALVE SET, FLOAT AND/OR FLOAT SET	0.3
3	16013-ZEO-005	FLOAT SET	1			4 3111A3	CHAMBER SET, FLOAT AND/OR GASKET, FLOAT CHAMBER	0.2
4	16015-ZEO-831	CHAMBER SET, FLOAT	1			5 3111D7	SCREW SET, PILOT	0.2
5	16016-ZH7-W01	SCREW SET, PILOT	1			9 3111F3	CARBURETOR	0.2
6	16024-ZE1-811	SCREW SET, DRAIN	1			12 3111C0	INSULATOR, CARBURETOR AND/OR PACKING, INSULATOR	0.2
7	16028-ZEO-005	SCREW SET	1			15 3111C8	PACKING, CARBURETOR	0.2
8	16045-ZE7-005	CHOKE SET	1			19 3101C5	PACKING, FUEL COCK	0.2
9	16100-Z1V-J71	CARBURETOR ASSY. (BEG6M A)	1			21 3111C3	JET, MAIN	0.3
10	16100-Z1V-003	CARBURETOR ASSY. (BEG6J A)	1					
11	16124-ZEO-005	SCREW, THROTTLE STOP	1					
12	16166-Z1V-J71	NOZZLE, MAIN	1					
13	16166-Z1V-003	INSULATOR, CARBURETOR	1					
14	16211-ZE7-000	PACKING, INSULATOR	1					
15	16212-ZE7-M10	SPACER COMP., CARBURETOR	1					
16	16220-ZE6-010	PACKING, CARBURETOR	1					
17	16221-ZE7-M11	PACKING, CARBURETOR	1					
18	16953-ZE1-812	LEVER, COCK	1					
19	16954-ZE1-812	PLATE, LEVER SETTING	1					
20	16956-ZE1-811	SPRING, COCK LEVER	1					
21	16957-ZE1-812	PACKING, FUEL COCK	1					
22	93500-03006-1H	SCREW, PAN, 3X6	2					
23	99101-ZH8-0600	JET, MAIN, #60	(1)					
24	99101-ZH8-0620	JET, MAIN, #62	(1)					



E-14

CARBURETOR

C13

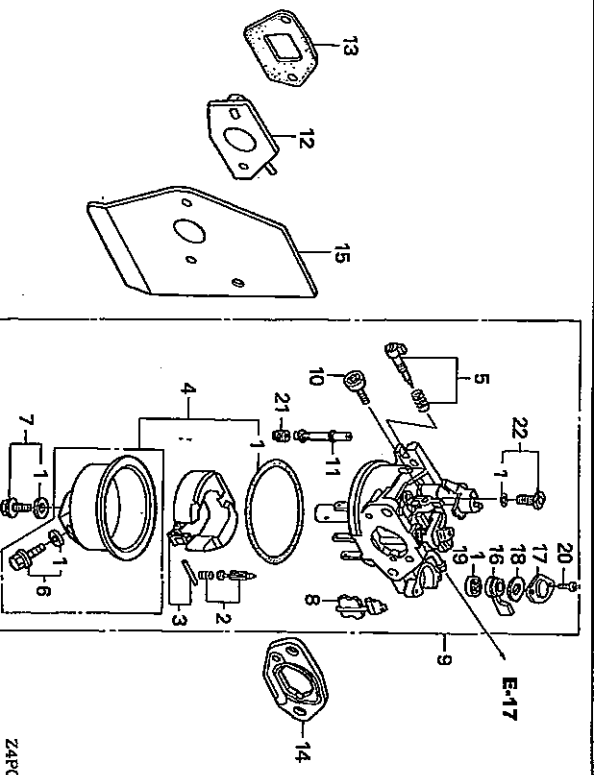

Ref. No.	Part No.	Description	Reqd. QTY	Serial No.	Parts catalogue code
----------	----------	-------------	-----------	------------	----------------------

21)	99101-ZH8-0650	JET, MAIN, #65	1	UH2	
	99101-ZH8-0680	JET, MAIN, #68	(1)		A1S, A1SA, A14, N1, N1F, N15, N4, N45, N55, SFL, SFL1, SFY, SFY1, TTAH
	22	99204-ZED-0350	1		N5M
		JET SET, PILOT, #35	1		N5M

E-15

AIR CLEANER

C14

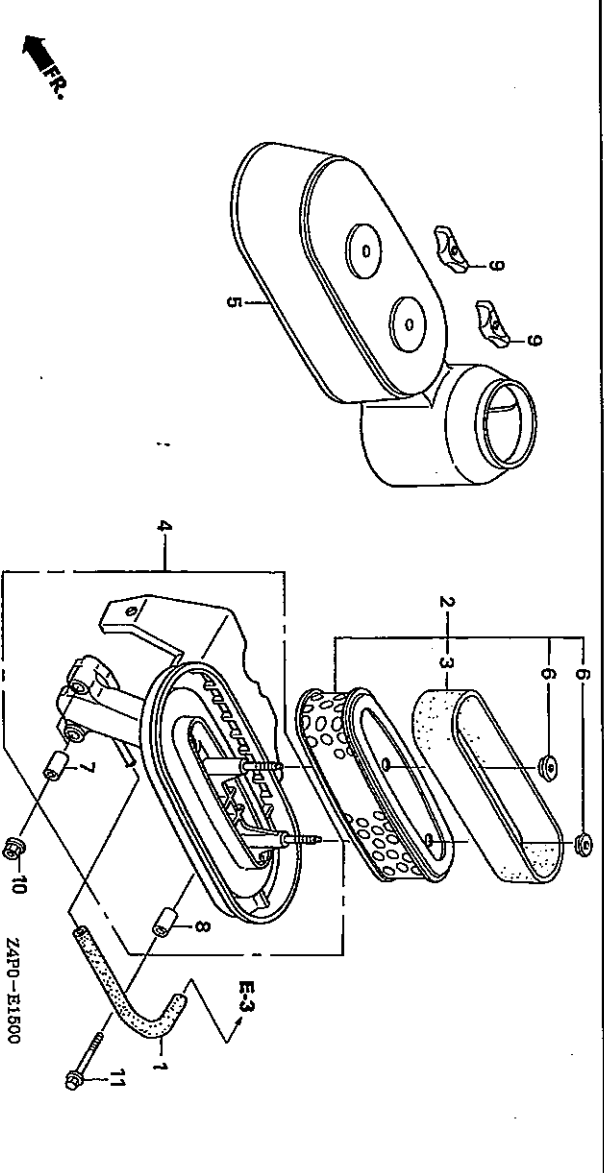

Ref. No.	Part No.	Description	Reqd. QTY	Serial No.	Parts catalogue code
1	15721-ZE7-000	TUBE, BREATHER	1		1 1111K5
2	17210-Z1V-003	ELEMENT, AIR CLEANER	1		2 3121B8
3	17218-888-003	FILTER, OUTER	1		3 3121C1
4	17220-Z1V-000	CASE COMP., AIR CLEANER	1		4 3121A5
5	17231-Z1V-000	COVER, AIR CLEANER	1		5 3121B1
6	17232-891-000	GROMMET, AIR CLEANER	2		
7	17238-ZE7-710	COLLAR, AIR CLEANER	2		
8	17239-ZE6-300	COLLAR, B, AIR CLEANER	1		
9	90300-Z1V-000	NUT, AIR CLEANER	2		
10	94050-06000	NUT, FLANGE, 6MM	2		
11	95701-06035-00	BOLT, FLANGE, 6X35	1		



E-16

MUFFLER

C15

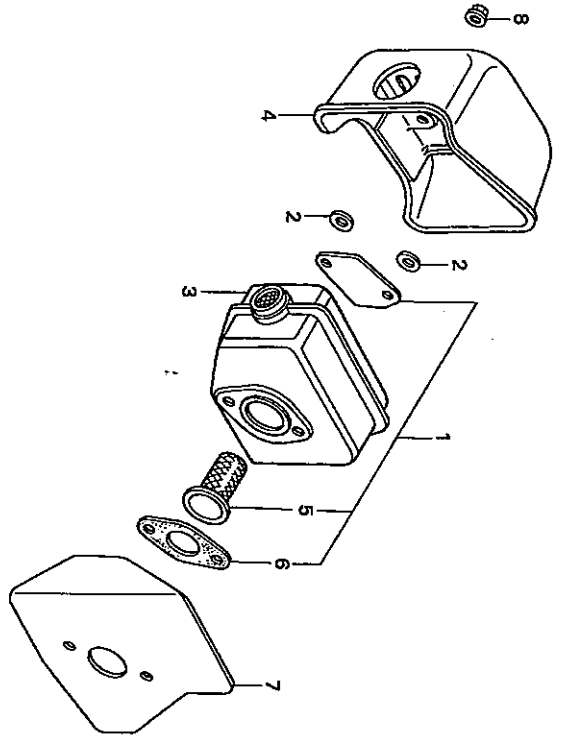

Z4P0-E1600

Ref. No.	L.O.N.	(Relative ref. Number)	Description	F.R.T.
1	3131A0		ARRESTER KIT, SPARK	0.2
3	3131C5		MUFFLER, EXHAUST	0.2
4	3131D6		PROTECTOR, EXHAUST MUFFLER	0.1
5	3131A1		ARRESTER, SPARK	0.2
6	3131B4		GASKET, EXHAUST MUFFLER	0.2

Ref. No.	Part No.	Description	Reqd. QTY	Serial No.	Parts catalogue code
1	06180-ZE6-820	ARRESTER KIT, SPARK	(1)		
2	18292-ZE7-M10	PACKING, PROTECTOR	2		
3	18310-Z1V-000	MUFFLER COMP.	1		
4	18320-Z1V-000	PROTECTOR COMP., MUFFLER	1		
5	18355-888-810	ARRESTER, SPARK	(1)		
6	18381-ZE6-820	GASKET, MUFFLER	(1)		
7	18381-Z1V-000	GASKET, MUFFLER	1		
8	90343-ZE6-000	NUT, SELF-LOCK, 6MM	2		

A1S,A1SA,A14,A1F,A15,N4,N45,N5M,N55,SFL,SFL1,SFY,SFY1

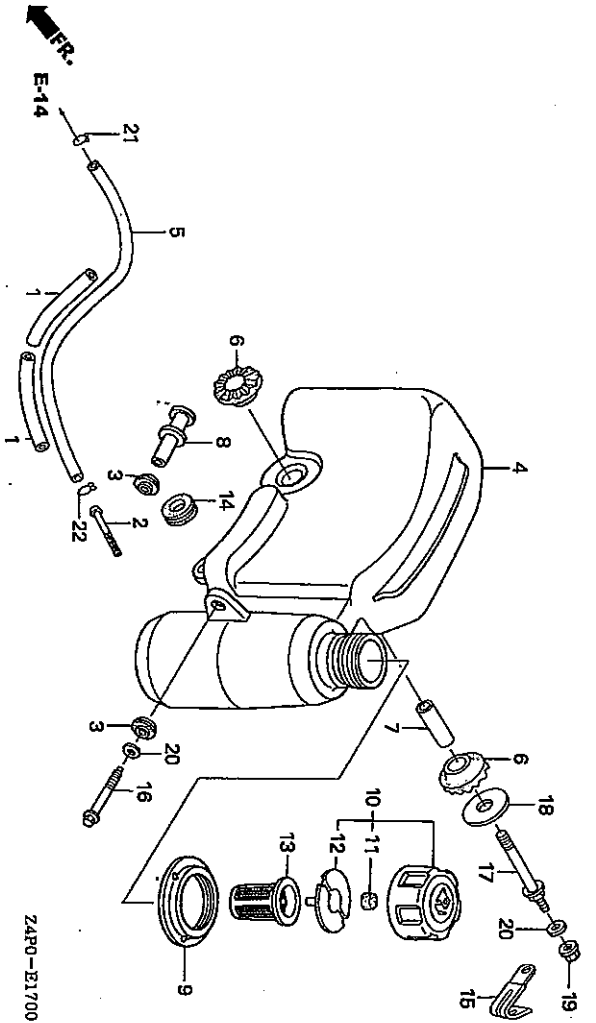

Ref. No.	L.O.N. (Relative ref. Number)	Description	F.R.T.
2	3101H8	STRAINER, FUEL	0.2
4	3101H7	TANK, FUEL	0.2
5	3101F6	TUBE, FUEL	0.1
6	3101M0	RUBBER B, TANK MOUNTING	0.2
.NOTE: Same time for two units			
12	3101L9	PACKING, FUEL CAP	0.1
13	3101M1	GAUGE, FUEL LEVEL	0.1

Ref. No.	Part No.	Description	Reqd. QTY	Serial No.	Parts catalogue code
1	16854-ZH8-000	RUBBER, SUPPORTER (107MM)	2		
2	16952-Z1V-000	STRAINER, FUEL	1		
3	17506-ZE7-000	RUBBER, TANK SETTING	2		
4	17510-Z1V-010	TANK COMP., FUEL	1		
5	17512-ZE7-000	TUBE, FUEL	1		
6	17516-896-700	RUBBER B, TANK MOUNTING	2		
7	17518-Z1V-000	COLLAR, TANK SET	1		
8	17519-Z1V-000	COLLAR COMP., TANK	1		
9	17532-Z1V-000	RUBBER, TANK MOUNTING	1		
10	17620-Z1V-000	CAP ASSY., FUEL TANK	1		
11	17622-888-010	SPONGE, FUEL CAP BREATHER	1		
12	17624-ZE7-000	PACKING, FUEL CAP	1		
13	17636-Z1V-010	GAUGE, FUEL LEVEL	1		
14	80103-MG2-000	CUSHION, RR. FENDER	1		
15	90010-GE0-710	CLIP, TUBE	1		A1S,A14
16	90014-Z1V-000	BOLT, FLANGE, 6X47(CT200)	1		
17	90016-Z1V-000	BOLT, TANK STAY	1		
18	90455-896-700	WASHER, TANK MOUNTING	1		
19	94050-06000	NUT, FLANGE, 6MM	1		
20	94103-06000	WASHER, PLAIN, 6MM	2		
21	95002-02080	CLIP, TUBE (B8)	1		
22	95002-70000	CLIP, TUBE (C11)	1		



E-19

FLYWHEEL(1)

D 1

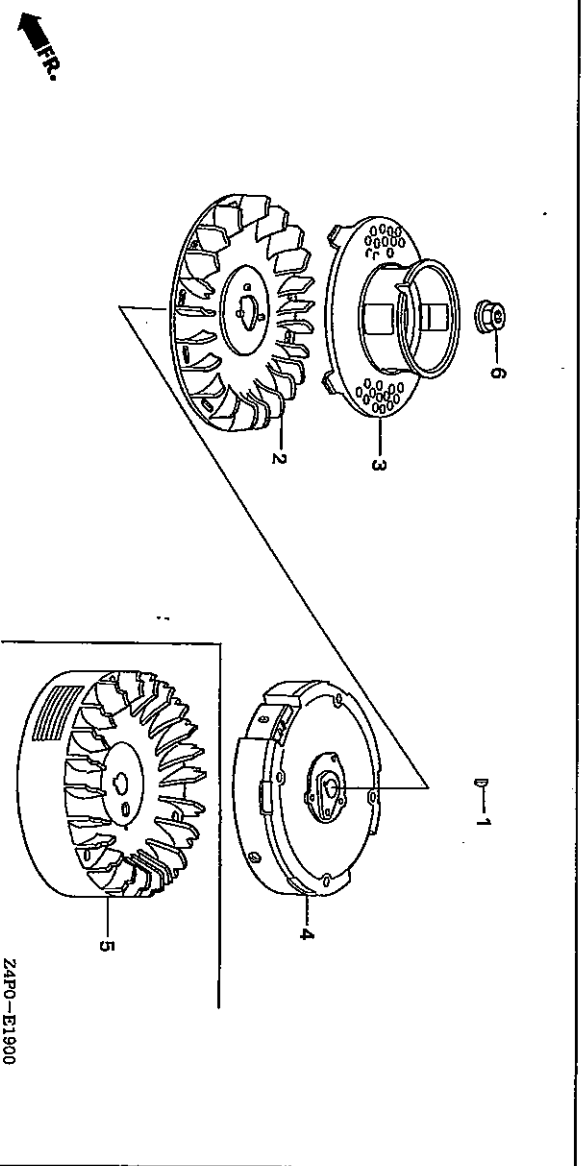

Ref. No.	L.O.N.	(Relative ref. Number)	Description	F.R.T.
2	1141G7		FAN, ENGINE COOLING	0.2
3	1121A9		PULLEY, RECOIL STARTER	0.2
4	2161B5	(5)	FLYWHEEL	0.3

Ref. No.	Part No.	Description	Reqd. QTY	Serial No.	Parts catalogue code
			gxy 160 UH2		
1	13331-357-000	KEY, SPECIAL WOODRUFF, 25X18	1	N1,N1F,N15,N4,N45,N5M,N55,SFL,SFL1,SFY,SFY1,T1AH	
2	19511-21T-000	FAN, COOLING	1	N1F,N5M,SFL,SFL1,SFY,SFY1	
3	28450-21V-000	PULLEY COMP., STARTER	1	N1,N1F,N15,N4,N45,N5M,N55,SFL,SFL1,SFY,SFY1,T1AH	
4	31110-21V-003	FLYWHEEL COMP.	1	N1F,N5M,SFL,SFL1,SFY,SFY1	
5	31110-21V-810	FLYWHEEL COMP. (BRAKE)	1	N1,N15,N4,N45,N55,T1AH	
6	90201-21T-000	NUT, SPECIAL, 14MM	1	N1,N1F,N15,N4,N45,N5M,N55,SFL,SFL1,SFY,SFY1,T1AH	

2

E-19-1

FLYWHEEL(2)

D 2

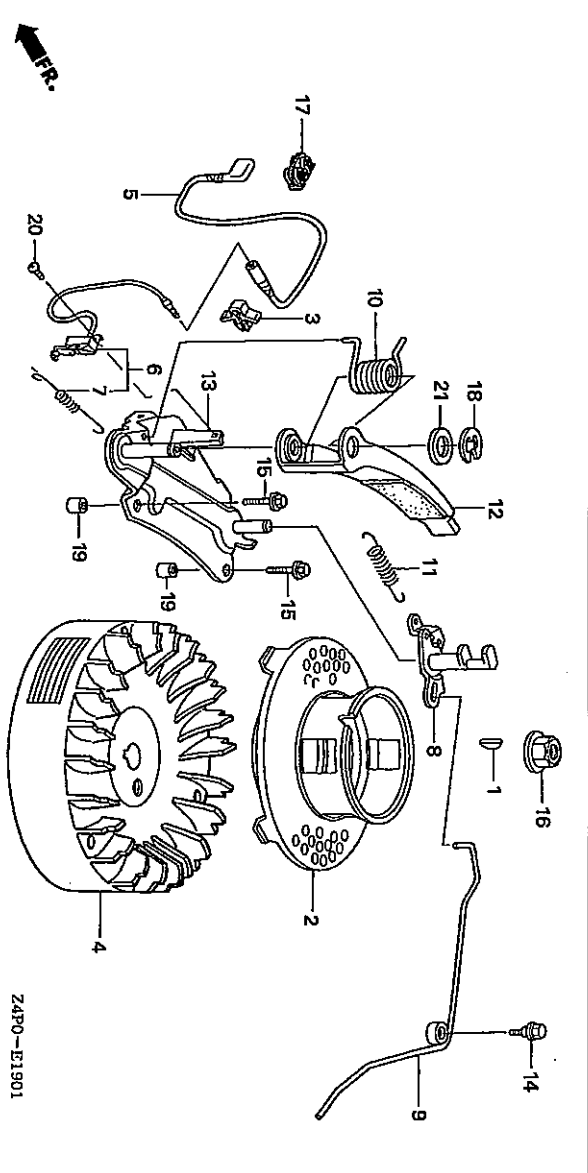

ZAP0-E1901

Ref. No.	L.O.N.	(Relative ref. Number)	Description	F.R.T.
2	1121A9		PULLEY, RECOIL STARTER	0.2
4	2161B5		FLYWHEEL	0.3
6	6151D9		SWITCH, ENGINE STOP	0.3
8	2161G3		CAM, FLYWHEEL BRAKE	0.4
10	2161G2		SPRING, FLYWHEEL BRAKE	0.4
11	2161G1		SPRING, FLYWHEEL BRAKE RETURN	0.4

Ref. No.	Part No.	Description	Reqd. QTY	Serial No.	Parts catalogue code
			GVV 160 UH2		

1	13331-357-000	KEY, SPECIAL WOODRUFF, 25X18	1	A1S, A1SA, A14	
2	28450-21V-000	PULLEY COMP., STARTER	1	A1S, A1SA, A14	
3	30701-883-000	CLIP, HIGH TENSION CORD (8MM)	1	A1S, A1SA, A14	
4	31110-21V-810	FLYWHEEL COMP. (BRAKE)	1	A1S, A1SA, A14	
5	32195-21V-810	CORD, STOP SWITCH (BRAKE)	1	A1S, A1SA, A14	
6	35120-21V-811	SWITCH ASSY., ENGINE STOP (BRAKE)	1	A1S, A1SA, A14	
7	35129-21V-811	SPRING, SWITCH CONTROL	1	A1S, A1SA, A14	
8	43140-21V-000	CAM COMP., BRAKE	1	A1S, A1SA, A14	
9	43145-2E7-003	ROD, THROTTLE RETURN	1	A1S, A1SA, A14	
10	75112-2E6-000	SPRING, BRAKE	1	A1S, A1SA, A14	
11	75113-2E6-000	SPRING, BRAKE RETURN	1	A1S, A1SA, A14	
12	75120-2E6-013	BRAKE COMP.	1	A1S, A1SA, A14	
13	75130-2E7-000	BASE COMP., BRAKE	1	A1S, A1SA, A14	
14	90015-2E6-000	BOLT, FLANGE, 6MM	1	A1S, A1SA, A14	
15	90018-2E1-000	BOLT, FLANGE, 6X23(CT200)	2	A1S, A1SA, A14	
16	90201-21T-000	NUT, SPECIAL, 14MM	1	A1S, A1SA, A14	
17	90505-MCT-000	CLAMP, PIPE	1	A1S, A1SA, A14	
18	90653-723-000	E-RING, 10MM	1	A1S, A1SA, A14	
19	90702-2E6-000	DOWEL PIN, 8X9	2	A1S, A1SA, A14	
20	93500-04008-0A	SCREW, PAN, 4X8	1	A1S, A1SA, A14	
21	94102-12800	WASHER, PLAIN, 12MM	1	A1S, A1SA, A14	



CONTROL(1)

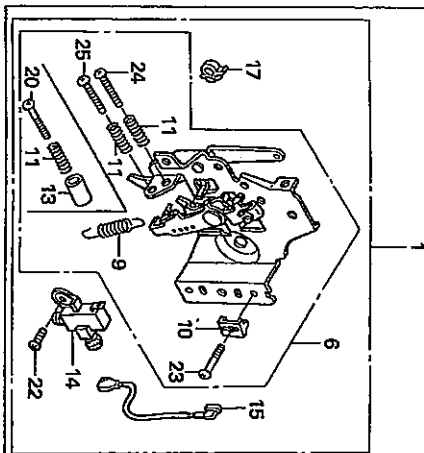
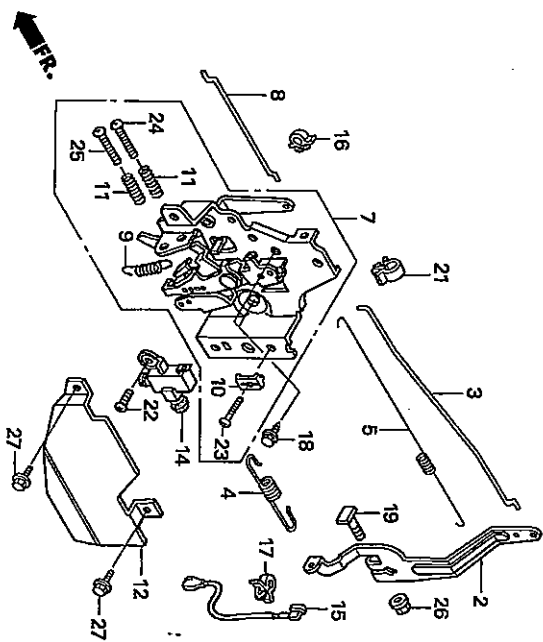

Z4P0-E2200

Ref. No. L.O.N. (Relative ref. Number) Description F.R.T.

1	1161A5	(7)	CONTROL, THROTTLE/GOVERNOR ...	0.3
2	1161AD		ARM, GOVERNOR	0.3
3	1161B1		ROD, GOVERNOR	0.3
4	1161C5		SPRING, GOVERNOR	0.2
5	1161C2		SPRING, THROTTLE RETURN	0.3
8	8101R5		ROD, GOVERNOR CHOKE CONTROL	0.2
9	1161CD		SPRING, LEVER	0.1
14	6151K1		SWITCH, THROTTLE/GOVERNOR ENGINE STOP	0.2
15	6111B3		CORD, STOP SWITCH	0.2

Ref. No.	Part No.	Description	Reqd. QTY	Serial No.	Parts catalogue code
----------	----------	-------------	-----------	------------	----------------------

1	16500-ZE7-W31	CONTROL ASSY.	1		SFL,SFL1,SFY,SFY1
2	16531-ZE7-000	ARM, GOVERNOR	1		N1,N4,NSM,SFL,SFL1,SFY,SFY1,T1AH
3	16555-ZE7-000	ROD, GOVERNOR	1		N1,N4,NSM,SFL,SFL1,SFY,SFY1,T1AH
4	16561-ZE7-020	SPRING, GOVERNOR	1		N1,N4,SFL,SFL1,SFY,SFY1,T1AH
5	16561-ZE7-711	1		NSM
5	16562-ZE6-000	SPRING, THROTTLE RETURN	1		N1,N4,NSM,SFL,SFL1,SFY,SFY1,T1AH
6	16570-ZE7-W10	CONTROL COMP.	1		SFL,SFL1,SFY,SFY1
7	16570-ZE7-772	1		NSM
7	16570-ZE7-020	CONTROL ASSY.	1		N1,N4,T1AH
8	16573-ZE7-000	ROD, CHOKE	1		N1,N4,NSM,SFL,SFL1,SFY,SFY1,T1AH
9	16576-ZE7-300	SPRING, LEVER	1		N1,N4,NSM,SFL,SFL1,SFY,SFY1,T1AH
10	16576-891-000	HOLDER, CABLE	1		N1,N4,NSM,SFL,SFL1,SFY,SFY1,T1AH
11	16584-883-300	SPRING, CONTROL ADJUSTING	2		N1,N4,NSM,SFL,SFL1,SFY,SFY1,T1AH
12	16585-ZE7-000	PROTECTOR, CONTROL	1		N1,N4,NSM,SFL,SFL1,SFY,SFY1,T1AH
13	16599-ZG1-M10	COLLAR, STOPPER	1		SFL,SFL1,SFY,SFY1
14	36100-ZE7-013	SWITCH ASSY., ENGINE STOP	1		N1,N4,NSM,SFL,SFL1,SFY,SFY1,T1AH
15	36101-ZE7-020	CORD, STOP SWITCH	1		N1,N4,NSM,SFL,SFL1,SFY,SFY1,T1AH
16	36103-ZE1-000	HOLDER, STOP SWITCH CORD	1		N1,N4,NSM,SFL,SFL1,SFY,SFY1,T1AH
17	46392-SC2-003	CLAMP, BRAKE PIPE (GRAY)	1		N1,N4,NSM,SFL,SFL1,SFY,SFY1,T1AH
18	90013-883-000	BOLT, FLANGE, 6X12(CT200)	2		N1,N4,NSM,SFL,SFL1,SFY,SFY1,T1AH
19	90015-ZE5-010	BOLT, GOVERNOR ARM	1		N1,N4,NSM,SFL,SFL1,SFY,SFY1,T1AH
20	90016-ZE7-W00	SCREW, RECESSED, 5X28	1		SFL,SFL1,SFY,SFY1
21	90659-680-013	CLIP, WIRE HARNESS	1		N1,N4,NSM,SFL,SFL1,SFY,SFY1,T1AH
22	93500-04008-0A	SCREW, PAN, 4X8	1		N1,N4,NSM,SFL,SFL1,SFY,SFY1,T1AH
23	93500-05016-0A	SCREW, PAN, 5X16	1		N1,N4,NSM,SFL,SFL1,SFY,SFY1,T1AH

E-22

CONTROL(1)

D 4

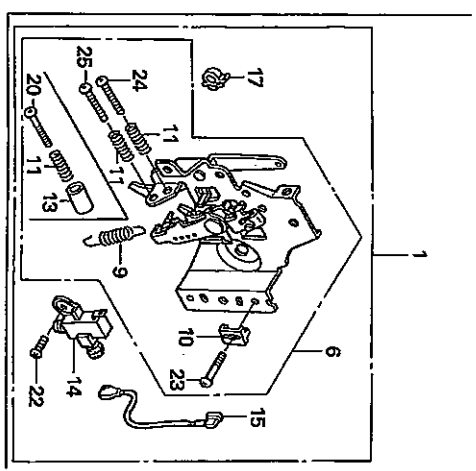
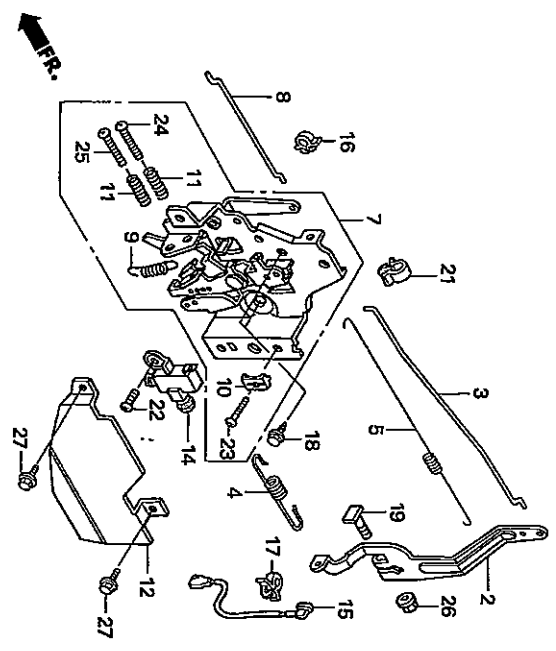

Ref. No.	Part No.	Description	Reqd. QTY	Serial No.	Parts catalogue code
----------	----------	-------------	-----------	------------	----------------------

24	93500-05020-0A	SCREW, PAN, 5X20	1	N1,N4,NSM,SFL,SFL1,SFY,SFY1,T1AH	
25	93500-05028-0A	SCREW, PAN, 5X28	1	N1,N4,NSM,T1AH	
26	94050-06000	NUT, FLANGE, 6MM	1	N1,N4,NSM,SFL,SFL1,SFY,SFY1,T1AH	
27	95701-06010-00	BOLT, FLANGE, 6X10	2	N1,N4,NSM,SFL,SFL1,SFY,SFY1,T1AH	



E-22-1

CONTROL(2)

D 5

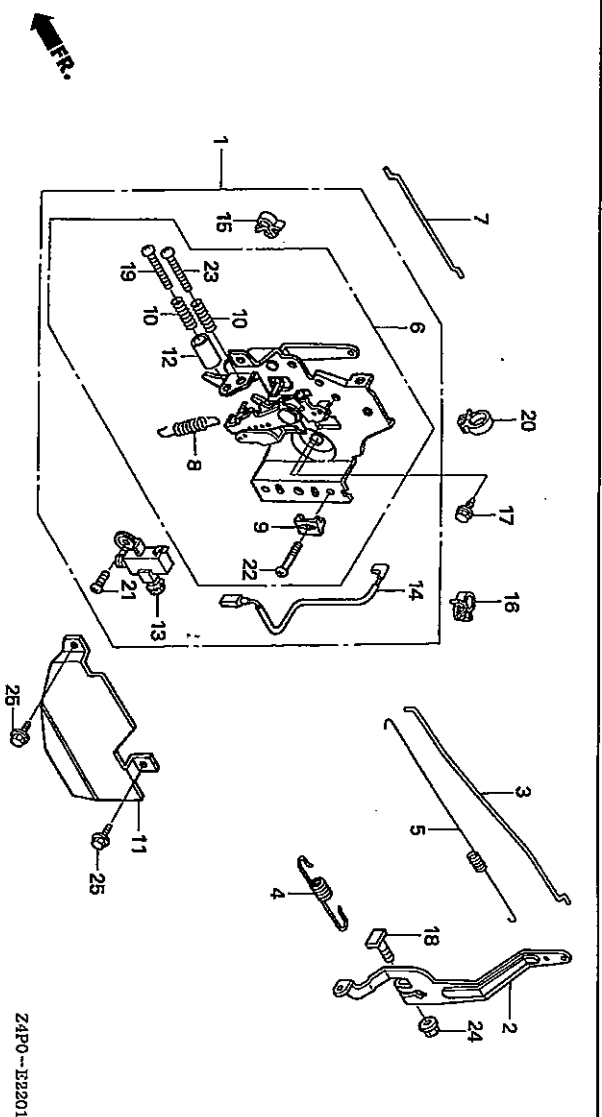

Ref. No.	L.O.N.	(Relative ref. Number)	Description	F.R.T.
1	1161A5	(6)	CONTROL, THROTTLE/GOVERNOR ...	0.3
2	1161A0		ARM, GOVERNOR	0.3
3	1161B1		ROD, GOVERNOR	0.3
4	1161C5		SPRING, GOVERNOR	0.2
5	1161C2		SPRING, THROTTLE RETURN	0.3
7	810TR5		ROD, GOVERNOR CHOKE CONTROL ..	0.2
8	1161E4		SPRING, LEVER(A)	0.2
13	6151K1		SWITCH, THROTTLE/GOVERNOR ENGINE STOP	0.2
14	6111B3		CORD, STOP SWITCH	0.2

Ref. No.	Part No.	Description	Reqd. QTY	Serial No.	Parts catalogue code
1	16500-ZE7-W11	CONTROL ASSY. (EN)(STD.)	1	-----	N1F,N15,N45,N55
2	16531-ZE7-000	ARM, GOVERNOR	1	-----	A1S,A1SA,A14,N1F,N15,N45,N55
3	16555-ZE7-000	ROD, GOVERNOR	1	-----	A1S,A1SA,A14,N1F,N15,N45,N55
4	16561-ZE7-020	SPRING, GOVERNOR	1	-----	A1S,A1SA,A14,N1F,N15,N45,N55
5	16562-ZE6-000	SPRING, THROTTLE RETURN	1	-----	A1S,A1SA,A14,N1F,N15,N45,N55
6	16570-ZE7-W00	CONTROL COMP. (STD.)	1	-----	A14,N1F,N15,N45,N55
7	16570-ZE7-W20	CONTROL COMP. (EN)(BRILL)	1	-----	A1S,A1SA
8	16573-ZE7-000	ROD, CHOKE	1	-----	A1S,A1SA,A14,N1F,N15,N45,N55
9	16576-ZE7-300	SPRING, LEVER	1	-----	A1S,A1SA,A14,N1F,N15,N45,N55
9	16576-891-000	HOLDER, CABLE	1	-----	A1S,A1SA,A14,N1F,N15,N45,N55
10	16584-883-300	SPRING, CONTROL ADJUSTING ...	2	-----	A1S,A1SA,A14,N1F,N15,N45,N55
11	16585-ZE7-000	PROTECTOR, CONTROL	1	-----	A1S,A1SA,N1F,N15,N45,N55
12	16599-ZG1-M10	COLLAR, STOPPER	1	-----	A1S,A1SA,A14,N1F,N15,N45,N55
13	36100-ZE7-013	SWITCH ASSY., ENGINE STOP ...	1	-----	N1F,N15,N45,N55
14	36101-ZE7-020	CORD, STOP SWITCH	1	-----	N1F,N15,N45,N55
15	36103-ZE1-000	HOLDER, STOP SWITCH CORD ...	1	-----	N1F,N15,N45,N55
16	46392-8C2-003	CLAMP, BRAKE PIPE (GRAY)	1	-----	N1F,N15,N45,N55
17	90013-883-000	BOLT, FLANGE, 6X12(CT200) ...	2	-----	A1S,A1SA,A14,N1F,N15,N45,N55
18	90015-ZE5-010	BOLT, GOVERNOR ARM	1	-----	A1S,A1SA,A14,N1F,N15,N45,N55
19	90016-ZE7-W00	SCREW, RECESSED, 5X28	1	-----	A1S,A1SA,A14,N1F,N15,N45,N55
20	90559-680-013	CLIP, WIRE HARNESS	1	-----	A1S,A1SA,A14,N1F,N15,N45,N55
21	93500-04008-0A	SCREW, PAN, 4X8	1	-----	N1F,N15,N45,N55
22	93500-05016-0A	SCREW, PAN, 5X16	1	-----	A1S,A1SA,A14,N1F,N15,N45,N55
23	93500-05020-0A	SCREW, PAN, 5X20	1	-----	A1S,A1SA,A14,N1F,N15,N45,N55
24	94050-06000	NUT, FLANGE, 6MM	1	-----	A1S,A1SA,A14,N1F,N15,N45,N55
25	95701-06010-00	BOLT, FLANGE, 6X10	2	-----	A1S,A1SA,N1F,N15,N45,N55

Z490--E2201

Reqd. QTY
: gxy
160
UH2

Parts catalogue code



Ref. L.O.N. (Relative ref. Number) F.R.T.
 No. Description

NO INFORMATION

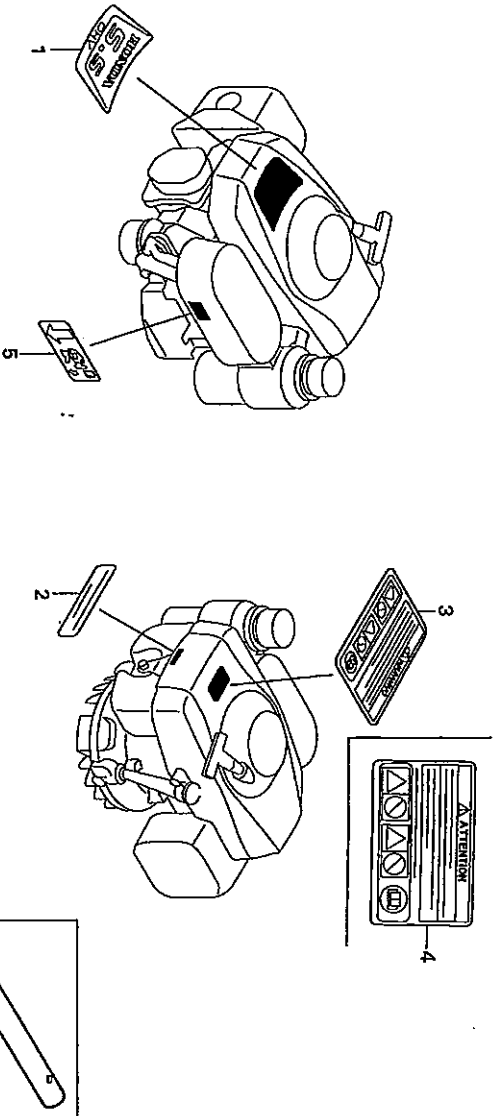

Ref. No.	Part No.	Description	Reqd QTY	Serial No.	Parts catalogue code
			EXV		
			160		
			UH2		

1	87101-21V-000	MARK, EMBLEM	1		
2	87504-21V-000	MARK, MANUFACTURER	1		
3	87516-24N-000	MARK, OPERATOR CAUTION (ENGLISH) (MADE IN CHINA)	1		
	87516-24N-810	MARK, OPERATOR CAUTION (FRENCH) (MADE IN CHINA)	(1)		
4	87516-24N-800	MARK, OPERATOR CAUTION (PICTOGRAPH) (MADE IN CHINA)	1		
5	87524-21V-000	MARK, FUEL COCK CAUTION	1		
6	99004-21002	WRENCH, BOX (P21)	1		SFL1,SFY,SFY1
	99004-21003	1		N1,N15,N4,N45,N5M,N55,T1AH

E-40

BLADE HOLDER

D 7

Ref. L.O.N. (Relative ref. Number) F.R.T.
 No. Description

NO INFORMATION

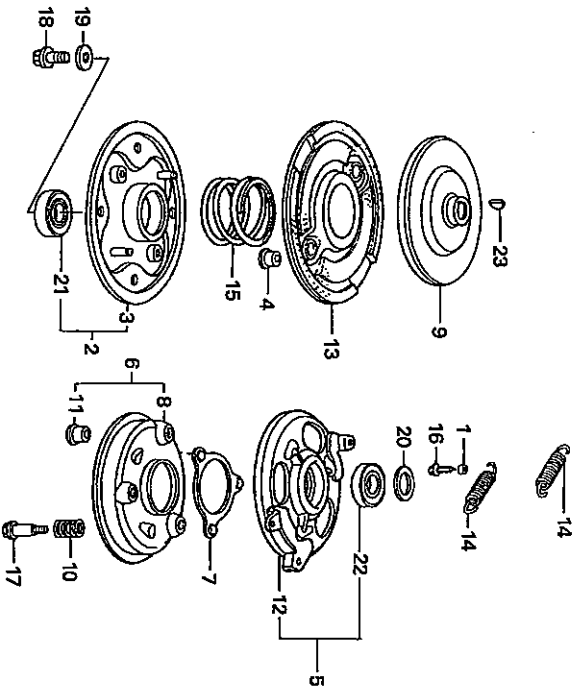

ZAP0-EA000

Ref. No.	Part No.	Description	Reqd. QTY exv 160 UHZ	Serial No.	Parts catalogue code
1	19512-883-000	COLLAR, FAN	2	-----	SFL1,SFY1
2	72600-VA4-010	HOLDER ASSY., BLADE	1	-----	SFL1,SFY1
3	72610-VA4-000	HOLDER COMP., BLADE	1	-----	SFL1,SFY1
4	72613-VA4-000	BUSH, BLADE HOLDER	2	-----	SFL1,SFY1
5	75090-VA4-030	PLATE ASSY., BALL CONTROL ...	1	-----	SFL1,SFY1
6	75100-VA4-010	BRAKE COMP.	1	-----	SFL1,SFY1
7	75110-VA4-000	RETAINER COMP., BALL	1	-----	SFL1,SFY1
8	75120-VA4-010	DISK, BRAKE	1	-----	SFL1,SFY1
9	75130-VA4-000	DISK, DRIVE	1	-----	SFL1,SFY1
10	75132-VA4-000	SPRING, BRAKE HOLDER	3	-----	SFL1,SFY1
11	75133-VA4-000	BUSH, BRAKE HOLDER	3	-----	SFL1,SFY1
12	75140-VA4-020	PLATE COMP., BALL CONTROL ...	1	-----	SFL1,SFY1
13	75150-VA3-J01	DISK COMP., DRIVEN	1	-----	SFL1,SFY1
14	75182-VA3-J00	SPRING, CLUTCH RETURN (53.0MM)	1	-----	SFL1,SFY1
15	75183-VA3-J00	SPRING, CLUTCH (36.6MM)	1	-----	SFL1,SFY1
16	90014-952-000	BOLT, FLANGE, 6X14(CT200) ...	4	-----	SFL1,SFY1
17	90021-VA4-000	BOLT, SPECIAL, 6MM	3	-----	SFL1,SFY1
18	90105-960-003	BOLT, HEX., 10X25	1	-----	SFL1,SFY1
19	90409-952-000	WASHER, 10MM	1	-----	SFL1,SFY1
20	90501-952-010	WASHER, THRUST	1	-----	SFL1,SFY1
21	91102-VA4-013	BEARING, RADIAL BALL, 6204 ..	1	-----	SFL1,SFY1
22	91103-VA4-003	BEARING, RADIAL BALL, 60/22 ..	1	-----	SFL1,SFY1
23	94401-16150	KEY, WOODRUFF, 16X15	1	-----	SFL1,SFY1

PART NO. INDEX

Part Number	Address	Page	Ref.	Part Number	Address	Page	Ref.	Part Number	Address	Page	Ref.	Part Number	Address	Page	Ref.	Part Number	Address	Page	Ref.
06000				14000				15700-ZEF-W00	D5	36	6	19610-Z1V-000ZB	C11	26	1	43000			
06180-ZE6-820	C15	30	1	14100-ZE7-000	C7	22	2	16570-ZE7-W10	D5	34	6	16570-ZE7-W20	D5	36	6	43140-Z1V-000	D2	33	8
11000				14100-ZE7-770	C7	22	2	16570-ZE7-000	D5	34	8	16575-ZE7-000	D5	34	8	43143-Z1V-000	C3	18	23
11300-Z1V-000	C2	17	2	14431-ZE1-010	C7	22	3	16576-ZE7-000	D5	36	10	16576-891-000	D5	36	10	43145-ZE7-003	D2	33	9
11300-Z1V-800	C2	17	2	14451-ZE1-013	C7	22	4	16576-ZE7-300	D5	36	9	16576-ZE7-300	D5	36	9	46000			
11300-Z1V-U90	C2	17	1	14568-ZE1-000	C7	22	5	16584-883-300	D5	34	8	16584-883-300	D5	34	8	46392-SC2-003	D3	34	17
11300-Z1V-V50	C2	17	1	14711-ZF1-000	C7	22	6	16585-ZE7-000	D5	36	11	16585-ZE7-000	D5	36	11	72000			
11381-ZE7-M10	C2	17	3	14721-ZE7-000	C7	22	7	16771-ZE1-000	D5	34	12	16771-ZE1-000	D5	34	12	72600-VA4-010	D7	38	2
12000				14771-ZE1-000	C7	22	8	14791-ZE1-010	C7	22	11	14791-ZE1-010	C7	22	11	72600-VA4-000	D7	38	3
12000-Z1V-000	C2	17	4	15335-ZE7-000	C2	17	11	16000				16000				72613-VA4-000	D7	38	4
12000-Z23-000	C2	17	4	15335-ZE7-000	C2	17	11	16000				16000				75000			
12125-Z1V-000	C2	17	5	15620-ZE6-810	C2	17	12	16854-ZH8-000	C16	31	1	16854-ZH8-000	C16	31	1	75090-VA4-030	D7	38	5
12126-Z1V-000	C2	17	6	15630-ZE6-810	C2	17	13	16952-Z1V-000	C16	31	2	16952-Z1V-000	C16	31	2	75100-VA4-010	D7	38	6
12126-Z1V-800	C2	17	6	15721-ZE7-000	C14	29	1	16953-ZE1-812	C12	27	17	16953-ZE1-812	C12	27	17	75110-VA4-000	D7	38	7
12204-ZE1-306	C1	16	16	16024-ZE1-811	C12	27	5	16954-ZE1-812	C12	27	18	16954-ZE1-812	C12	27	18	75113-ZE6-000	D2	33	11
12205-ZE1-315	C1	16	2	16028-ZE1-811	C12	27	6	16956-ZE1-811	C12	27	19	16956-ZE1-811	C12	27	19	75113-ZE6-000	D2	33	11
12209-ZE6-003	C7	16	2	16028-ZE1-811	C12	27	6	16957-ZE1-812	C12	27	19	16957-ZE1-812	C12	27	19	75113-ZE6-000	D2	33	11
12210-Z1V-000	C1	16	3	16028-ZE1-811	C12	27	6	17000				17000				75113-ZE6-000	D2	33	11
12216-ZE5-300	C1	16	4	16045-ZE7-005	C12	27	7	17239-ZE6-300	C14	29	8	17239-ZE6-300	C14	29	8	75113-ZE6-000	D2	33	11
12251-ZE7-000	C1	16	5	16045-ZE7-005	C12	27	7	17240-ZE6-000	C2	17	19	17240-ZE6-000	C2	17	19	75113-ZE6-000	D2	33	11
12311-ZE9-800	C1	16	6	16011-ZE0-005	C12	27	8	17506-ZE7-000	C16	31	4	17506-ZE7-000	C16	31	4	75120-VA4-010	D7	38	8
12355-Z1V-000	C2	17	7	16013-ZE0-005	C12	27	8	17510-Z1V-010	C16	31	4	17510-Z1V-010	C16	31	4	75120-ZE6-013	D2	33	12
12367-883-003	C2	17	8	16013-ZE0-831	C12	27	8	17516-896-700	C16	31	5	17516-896-700	C16	31	5	75130-VA4-000	D7	38	9
12373-ZE7-000	C2	17	9	16016-ZH7-M01	C12	27	5	17519-ZE7-000	C14	29	6	17519-ZE7-000	C14	29	6	75130-ZE7-000	D2	33	13
12391-ZE7-000	C1	16	10	16024-ZE1-811	C12	27	6	17523-8-ZE7-000	C14	29	7	17523-8-ZE7-000	C14	29	7	75132-VA4-000	D7	38	10
13000				16028-ZE1-811	C12	27	6	17523-8-ZE7-000	C14	29	7	17523-8-ZE7-000	C14	29	7	75133-VA4-000	D7	38	11
13010-Z10-003	C5	20	1	16028-ZE1-811	C12	27	6	17529-ZE6-300	C14	29	8	17529-ZE6-300	C14	29	8	75140-VA4-020	D7	38	12
13010-Z10-004	C5	20	1	16100-Z1V-003	C12	27	9	17506-ZE7-000	C16	31	4	17506-ZE7-000	C16	31	4	75150-VA3-101	D7	38	13
13011-Z10-003	C5	20	1	16100-Z1V-003	C12	27	9	17510-Z1V-010	C16	31	4	17510-Z1V-010	C16	31	4	75183-VA3-100	D7	38	14
13011-Z10-004	C5	20	1	16124-ZE0-005	C12	27	10	17516-896-700	C16	31	5	17516-896-700	C16	31	5	80000			
13012-Z10-003	C5	20	1	16166-Z1V-003	C12	27	11	17519-ZE7-000	C16	31	5	17519-ZE7-000	C16	31	5	80000			
13012-Z10-004	C5	20	1	16166-Z1V-003	C12	27	11	17519-ZE7-000	C16	31	5	17519-ZE7-000	C16	31	5	80000			
13013-Z10-003	C5	20	1	16212-ZE7-M10	C12	27	12	17518-Z1V-000	C16	31	6	17518-Z1V-000	C16	31	6	80000			
13013-Z10-004	C5	20	1	16212-ZE7-M10	C12	27	12	17518-Z1V-000	C16	31	6	17518-Z1V-000	C16	31	6	80000			
13013-Z10-005	C5	20	1	16221-ZE7-M11	C12	27	13	17532-Z1V-000	C2	17	20	17532-Z1V-000	C2	17	20	80000			
13013-Z10-004	C5	20	1	16221-ZE7-M11	C12	27	13	17532-Z1V-000	C2	17	20	17532-Z1V-000	C2	17	20	80000			
13013-Z10-005	C5	20	1	16221-ZE7-M11	C12	27	13	17532-Z1V-000	C2	17	20	17532-Z1V-000	C2	17	20	80000			
13013-Z10-004	C5	20	1	16221-ZE7-M11	C12	27	13	17532-Z1V-000	C2	17	20	17532-Z1V-000	C2	17	20	80000			
13013-Z10-005	C5	20	1	16221-ZE7-M11	C12	27	13	17532-Z1V-000	C2	17	20	17532-Z1V-000	C2	17	20	80000			
13013-Z10-004	C5	20	1	16221-ZE7-M11	C12	27	13	17532-Z1V-000	C2	17	20	17532-Z1V-000	C2	17	20	80000			
13013-Z10-005	C5	20	1	16221-ZE7-M11	C12	27	13	17532-Z1V-000	C2	17	20	17532-Z1V-000	C2	17	20	80000			
13013-Z10-004	C5	20	1	16221-ZE7-M11	C12	27	13	17532-Z1V-000	C2	17	20	17532-Z1V-000	C2	17	20	80000			
13013-Z10-005	C5	20	1	16221-ZE7-M11	C12	27	13	17532-Z1V-000	C2	17	20	17532-Z1V-000	C2	17	20	80000			
13013-Z10-004	C5	20	1	16221-ZE7-M11	C12	27	13	17532-Z1V-000	C2	17	20	17532-Z1V-000	C2	17	20	80000			
13013-Z10-005	C5	20	1	16221-ZE7-M11	C12	27	13	17532-Z1V-000	C2	17	20	17532-Z1V-000	C2	17	20	80000			
13013-Z10-004	C5	20	1	16221-ZE7-M11	C12	27	13	17532-Z1V-000	C2	17	20	17532-Z1V-000	C2	17	20	80000			
13013-Z10-005	C5	20	1	16221-ZE7-M11	C12	27	13	17532-Z1V-000	C2	17	20	17532-Z1V-000	C2	17	20	80000			
13013-Z10-004	C5	20	1	16221-ZE7-M11	C12	27	13	17532-Z1V-000	C2	17	20	17532-Z1V-000	C2	17	20	80000			
13013-Z10-005	C5	20	1	16221-ZE7-M11	C12	27	13	17532-Z1V-000	C2	17	20	17532-Z1V-000	C2	17	20	80000			
13013-Z10-004	C5	20	1	16221-ZE7-M11	C12	27	13	17532-Z1V-000	C2	17	20	17532-Z1V-000	C2	17	20	80000			
13013-Z10-005	C5	20	1	16221-ZE7-M11	C12	27	13	17532-Z1V-000	C2	17	20	17532-Z1V-000	C2	17	20	80000			
13013-Z10-004	C5	20	1	16221-ZE7-M11	C12	27	13	17532-Z1V-000	C2	17	20	17532-Z1V-000	C2	17	20	80000			
13013-Z10-005	C5	20	1	16221-ZE7-M11	C12	27	13	17532-Z1V-000	C2	17	20	17532-Z1V-000	C2	17	20	80000			
13013-Z10-004	C5	20	1	16221-ZE7-M11	C12	27	13	17532-Z1V-000	C2	17	20	17532-Z1V-000	C2	17	20	80000			
13013-Z10-005	C5	20	1	16221-ZE7-M11	C12	27	13	17532-Z1V-000	C2	17	20	17532-Z1V-000	C2	17	20	80000			
13013-Z10-004	C5	20	1	16221-ZE7-M11	C12	27	13	17532-Z1V-000	C2	17	20	17532-Z1V-000	C2	17	20	80000			
13013-Z10-005	C5	20	1	16221-ZE7-M11	C12	27	13	17532-Z1V-000	C2	17	20	17532-Z1V-000	C2	17	20	80000			
13013-Z10-004	C5	20	1	16221-ZE7-M11	C12	27	13	17532-Z1V-000	C2	17	20	17532-Z1V-000	C2	17	20	80000			
13013-Z10-005	C5	20	1	16221-ZE7-M11	C12	27	13	17532-Z1V-000	C2	17	20	17532-Z1V-000	C2	17	20	80000			
13013-Z10-004	C5	20	1	16221-ZE7-M11	C12	27	13	17532-Z1V-000	C2	17	20	17532-Z1V-000	C2	17	20	80000			
13013-Z10-005	C5	20	1	16221-ZE7-M11	C12	27	13	17532-Z1V-000	C2	17	20	17							

PART NO. INDEX

Part Number	Address	Page	Ref.	Part Number	Address	Page	Ref.	Part Number	Address	Page	Ref.	Part Number	Address	Page	Ref.
90014-952-000	C3	18	25	93500-05016-0A	C3	18	41								
90014-21V-000	D7	38	16		D3	34	23								
90015-883-000	C16	31	16		D5	36	22								
90015-ZE5-010	C11	26	4	93500-05020-0A	D4	35	24								
	D3	34	19		D5	36	23								
	D5	36	18	93500-05028-0A	D4	35	25								
90015-ZE6-000	D2	33	14												
90016-21V-000	C16	31	17	94000											
90016-ZE7-W00	D3	34	20												
	D5	36	19	94050-06000	C14	29	10								
90017-883-000	C3	18	26		C16	31	19								
90018-ZE1-000	D2	33	15		D4	35	26								
90021-VA4-000	D7	38	17		D5	36	24								
90022-888-010	C3	18	27	94101-06800	C3	18	42								
90043-ZE6-000	C1	16	10	94102-12800	D2	33	21								
90048-LC3-000	C1	16	11	94103-06000	C16	31	20								
90105-960-003	D7	38	18	94251-08000	C3	18	43								
90131-ZE1-000	C3	18	28	94301-08140	C3	18	44								
90201-Z1T-000	D1	32	6	94301-10160	C1	16	12								
	D2	33	16	94401-16150	D7	38	23								
90206-ZE1-000	C7	22	14												
90300-21V-000	C14	29	9	95000											
90343-ZE6-000	C15	30	8												
90401-ZE7-W00	C6	21	12	95002-02080	C16	31	21								
90409-952-000	D7	38	19	95002-70000	C16	31	22								
90451-ZE1-000	C3	18	29	95701-06008-00	C10	25	14								
90452-166-600	C3	18	30	95701-06010-00	D4	35	27								
90452-187-000	C3	18	30		D5	36	25								
90455-896-700	C16	31	18	95701-06012-08	C3	18	45								
90501-952-010	D7	38	20	95701-06035-00	C14	29	11								
90505-MCT-000	D2	33	17	95701-08050-00	C1	16	13								
90551-ZE1-000	C6	21	13		C4	19	46								
90581-Z1V-000	C11	26	5	96000											
90601-ZE1-000	C3	18	32												
90602-ZE1-000	C3	18	33	96100-62050-00	C4	19	47								
90653-723-000	D2	33	18												
90659-680-013	D3	34	21	98000											
	D5	36	20												
90701-ZE6-000	C3	18	34												
90702-ZE6-000	D2	33	19	98079-54846	C1	16	14								
90741-2V4-000	C6	21	14	98079-54855	C1	16	14								
				98079-55846	C1	16	14								
				98079-55855	C1	16	14								
				98079-56846	C1	16	14								
				98079-56855	C1	16	14								
91000				99000											
91102-VA4-013	D7	38	21	99004-21002	D6	37	6								
91103-VA4-003	D7	38	22	99004-21003	D6	37	6								
91205-21V-003	C3	18	35	99101-ZH8-0600	C12	27	21								
91231-21V-003	C3	18	36	99101-ZH8-0620	C13	28	21								
91251-21V-003	C3	18	37	99101-ZH8-0650	C13	28	21								
91252-21V-003	C3	18	38	99101-ZH8-0680	C13	28	21								
91301-21V-003	C3	18	39	99204-ZE0-0350	C13	28	22								
91302-21V-003	C3	18	40												
93000															
93500-03006-1H	C12	27	20												
93500-04008-0A	D2	33	20												
	D3	34	22												
	D5	36	21												



PART NAME INDEX

F 2

Part name	Address	Page	Ref.	Part name	Address	Page	Ref.	Part name	Address	Page	Ref.
[M]				[R]				[T]			
MARK, EMBLEM	D6	37	1	PROTECTOR, CONTROL	D5	36	11	SPRING, FRICTION	C10	25	7
MARK, FUEL COCK CAUTION	D6	37	5	PULLEY COMP., STARTER	D1	32	3	SPRING, GOVERNOR	D3	34	4
MARK, MANUFACTURER	D6	37	2		D2	35	2	SPRING, LEVER	D5	34	9
MARK, OPERATOR CAUTION	D6	37	3					SPRING, RECOIL STARTER	C10	25	8
MUFFLER COMP.	C15	30	4					SPRING, RETURN	C10	25	9
								SPRING, SWITCH CONTROL	D2	33	7
[N]								SPRING, THROTTLE RETURN	D3	34	5
NOZZLE, MAIN	C12	27	11	RATCHET, STARTER	C10	25	4	SPRING, VALVE	C7	36	5
NUT, AIR CLEANER	C14	29	9	REEL, RECOIL STARTER	C10	25	7	SPRING, WEIGHT RETURN	C7	22	10
NUT, FLANGE, 6MM	C16	31	10	RETAINER COMP., BALL	D7	38	3	SPRING, RECOIL	C10	25	7
				RETAINER, IN. VALVE SPRING	C7	22	11	STAY COMP., TANK	C2	31	20
				RING SET, PISTON	C5	20	4	STRAINER, FUEL	C16	31	2
				ROD ASSY., CONNECTING	C5	20	4	SWITCH ASSY., ENGINE STOP	D3	35	6
				ROD, CHOKE	D3	34	7		D5	34	14
				ROD, GOVERNOR	D5	36	3		D3	34	14
				ROD, PUSH	D5	36	3		D5	36	13
				ROD, THROTTLE RETURN	C7	22	9				
				ROPE, RECOIL STARTER	D2	35	9				
				RUBBER B, TANK MOUNTING	C10	25	12				
				RUBBER, OIL RETURN	C2	31	6				
				RUBBER, SUPPORTER	C16	31	1				
				RUBBER, TANK MOUNTING	C16	31	9				
				RUBBER, TANK SETTING	C16	31	3				
[O]				[S]							
OIL SEAL, 12X20X6.5	C3	18	35	SCREW SET	C12	27	7	VALVE SET, FLOAT	C12	27	2
OIL SEAL, 25X38X7	C3	18	37	SCREW SET, DRAIN	C12	27	6	VALVE, BREATHER	C2	17	9
OIL SEAL, 25.4X40X7	C3	18	38	SCREW SET, PILOT	C12	27	5	VALVE, EX.	C7	22	9
OIL SEAL, 6X11X4	C3	18	36	SCREW, PAN, 3X6	C12	27	20	VALVE, IN.	C7	22	8
O-RING, 22.1X2.2	C3	18	39	SCREW, PAN, 4X8	D2	35	20				
O-RING, 25.5X3	C3	18	40		D3	34	22				
					D5	36	21				
[P]					D5	36	21				
PACKING, BREATHER COVER	C2	17	10	SCREW, PAN, 5X16	C3	18	41	WASHER, 10MM	D7	38	19
PACKING, CARBURETOR	C12	27	15		C3	18	41	WASHER, 10X21	C3	18	31
PACKING, FUEL CAP	C16	31	12		D3	34	22	WASHER, DRAIN PLUG, 10.2MM	C3	18	32
PACKING, FUEL COCK	C12	27	19	SCREW, PAN, 5X20	D4	35	24	WASHER, PLAIN, 12MM	D2	35	21
PACKING, HEAD COVER	C1	16	7		D5	36	23	WASHER, PLAIN, 6MM	C3	18	42
PACKING, INSULATOR	C12	27	13	SCREW, PAN, 5X28	D4	35	25				
PACKING, OIL PAN	C2	17	3	SCREW, RECESSED, 5X28	D4	35	25				
PACKING, PROTECTOR	C15	30	2		D5	36	20	WASHER, TANK MOUNTING	C16	31	18
PAN ASSY., OIL	C2	17	1	SCREW, SETTING	C10	25	19	WASHER, THRUST	D7	38	20
				SCREW, THROTTLE STOP	C12	27	10	WASHER, THRUST, 12MM	C3	18	30
PIN, LOCK, 2.0	C3	18	34	SEAL, VALVE STEM	C7	22	1	WASHER, THRUST, 25.6MM	C6	21	12
PIN, LOCK, 8MM	C3	18	43	SHAFT, DRIVE	C2	17	21	WASHER, THRUST, 6MM	C3	18	29
PIN, PISTON	C5	20	3	SHAFT, GOVERNOR ARM	C2	17	18	WRENCH, BOX	D6	37	6
PISTON	C5	20	2	SHAFT, GOVERNOR HOLDER	C2	17	15				
PIVOT, ROCKER ARM	C7	22	6	SLIDER, GOVERNOR	C2	17	17				
PIVOT, ROCKER ARM	C7	22	6	SPACER COMP., CARBURETOR	C12	27	14				
PLATE ASSTY., BALL CONTROL	C2	17	5	SPONGE, FUEL CAP BREATHER	C16	31	11				
PLATE A, GUIDE	C2	17	6	SPRING, BRAKE	D2	33	10				
PLATE COMP., BALL CONTROL	D7	38	6	SPRING, BRAKE HOLDER	D7	38	10				
PLATE COMP., BALL CONTROL	D7	38	6	SPRING, BRAKE RETURN	D2	33	10				
PLATE, FRICTION	C10	25	12	SPRING, CLUTCH	D7	38	11				
PLATE, FRICTION SHAFT HOLDER	C2	17	17	SPRING, CLUTCH RETURN	D7	38	15				
PLATE, GUIDE	C2	17	5	SPRING, COCK LEVER	C12	27	18				
PLATE, LEVER SETTING	C12	27	17	SPRING, CONTROL ADJUSTING	D5	36	11				
PLATE, PUSH ROD GUIDE	C7	22	12								
PLATE, PUSH ROD GUIDE	C7	22	12								
PLUG, SPARK	C1	16	14								
PROTECTOR COMP., MUFFLER	C15	30	4								
PROTECTOR, CONTROL	D3	34	12								